

LYE® 莱伊尔

ELECTRICAL CABINET MANUFACTURER

电气机柜制造商



Aesthetic
distribution cabinet

美学配电柜

Beginning with the future Electricity Wisdom

始于对未来的 电力智慧



涑伊尔科技（浙江）股份有限公司是一家位于浙江温州的国家高新技术企业，专注于智慧配电箱、弱电箱、高低压柜的研发、生产与销售。公司以打造高品质、智能化配电设备为核心，致力于为客户提供安全、可靠的电力解决方案。

作为中国智能配电箱十大品牌及国家标准起草单位，涑伊尔拥有多项专利技术，产品通过ISO9001、ISO14001、OHSAS18001、CCC、CE、TUV等多项国内外权威认证，品质达国际先进水平。

公司已成为世界500强及行业龙头企业的优选供应商，市场占有率与客户满意度持续提升。涑伊尔以“成为中国智能电箱领导者”为愿景，秉持“合作、共享、利他、成长”的价值观，持续推动产品智能化与技术革新。

未来，涑伊尔将持续加大研发投入，积极拓展海内外市场，不断提升产品与服务，实现可持续高质量发展。



愿景Vision:

致力于成为中国电气机柜领域引领者

Dedicated to becoming a leader in China's electrical cabinet industry

使命Mission:

让电更安全、更智能

Make electricity safer and smarter

价值观Values:

合作、共享、利他、成长

Cooperation, sharing, altruism, growth

LYE Technology (Zhejiang) Co., Ltd. is a national high-tech enterprise located in Wenzhou, Zhejiang Province, specializing in the R&D, production and sales of smart power distribution boxes, low-voltage distribution boxes, and high-low voltage cabinets. With the core goal of creating high-quality and intelligent power distribution equipment, the company is committed to providing customers with safe and reliable power solutions.

As one of the Top 10 Brands of China's Smart Power Distribution Boxes and a drafter of national standards, LYE holds a number of patented technologies. Its products have obtained multiple authoritative certifications at home and abroad, including ISO9001, ISO14001, OHSAS18001, CCC, CE, and TUV, and their quality has reached the international advanced level.

The company has become a preferred supplier for Fortune Global 500 companies and industry leaders, with its market share and customer satisfaction continuing to rise. LYE takes "becoming a leader in China's smart power distribution boxes" as its vision and adheres to the values of "Cooperation, Sharing, Altruism, and Growth" to continuously promote product intelligence and technological innovation.

In the future, LYE will continue to increase R&D investment, actively expand domestic and overseas markets, constantly improve its products and services, and achieve sustainable and high-quality development.

智能制造加工中心

智能加工中心引进了德国通快技术的钣金智能柔性加工生产线、智能数控冲床分拣中心、ABB机器人智能折弯中心、ABB机器人激光焊接中心、智能激光切割分拣中心、RGV智能成套装配生产线、智能母排数控中心、MES系统等先进的工艺流程及检测设备。



▲ 智能母排数控中心



▲ ABB机器人激光焊接中心



▲ 智能柔性加工生产线

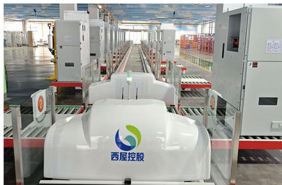

▲ RGV智能成套装配生产线



▲ 机器人智能折弯中心



▲ 数控折弯机

Intelligent manufacturing processing center

The Intelligent Processing Centre has introduced advanced processes and testing equipment such as intelligent flexible processing production line for sheet metal, intelligent CNC punching sorting centre, ABB robot laser welding centre, intelligent laser cutting sorting centre, RGV intelligent complete assembly production line, intelligent CNC centre for busbars and MES system, etc., which are based on the technology of Germany Tongxu.



▲智能激光切割分拣中心



▲雷电冲击试验装置



▲局放电磁屏蔽室



▲无线局放耐压试验装置



▲全自动热缩加工中心



▲全自动二次线加工中心

INNOVATION LEADS THE FUTURE

创新引领未来



The company has passed the certification of ISO 9001 quality management system, ISO 14001 environmental management system and ISO 45001 Occupational health and safety management system, and its core products have obtained the National Grid standard certification and EU CE and other international qualifications. Its independent research and development of submerged liquid cooling charging pile technology (energy efficiency of 97.6%) has 1 invention patent and a number of utility model patents, and cooperation with "Jingong Electric" to achieve market breakthroughs, to solve the pain points of the supercharge industry.



公司通过ISO 9001质量管理体系、ISO 14001环境管理体系及ISO 45001职业健康安全管理体系认证，核心产品获国家电网标准认证及欧盟CE等国际资质。其自主研发的浸没液冷充电桩技术（能效达97.6%）拥有16项发明专利及多项实用新型专利，并与“京工电”合作实现市场化突破，解决了超充堆行业痛点。



Continue to deepen
environmental protection and
intelligent technology,
Making power equipment safer

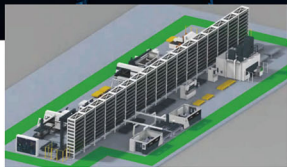

▲ 钣金自动化生产线



The company has obtained ISO 9001 Quality Management System, ISO 14001 Environmental Management System, and ISO 45001 Occupational Health and Safety Management System certifications, ensuring that its products meet international standards. Its core products have received State Grid Standard Certification and EU CE Certification, showcasing exceptional quality and safety.

The company holds multiple invention patents and utility model patents and continues to drive advancements in switchgear technology, striving to deliver safer, more efficient, and smarter power solutions.

LYE® 深伊尔 电气机柜制造商
Electrical cabinet manufacturer

致力于智能电气机柜设备的研发制造，
让电网系统更安全！更可靠！更智能！护航零碳未来！

Dedicated to the research and manufacturing
of intelligent electrical cabinet equipment,
Make the power grid system safer! More reliable!
More intelligent! Escort a zero carbon future!

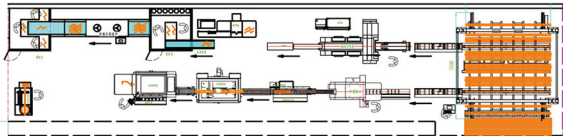

▲ 母排自动化生产线

技术中心作为公司新产品研究与开发的中枢，具备完善的研究与开发的能力。创新进取精神是一个企业发展的永恒动力，西屋控股将永远支持创新精神，永不安于现状。企业将在完善现有产品基础上，不断创新生产技术，发展各种优质的新产品以适合市场需要，增强企业的核心竞争力。



Future Energy Efficiency World,
We advocate for
sustainable development.

**未来能效世界，
我们倡导可持续发展。**

产品目录

Product Catalog

- 01** XL-21动力柜
XL-21 Power Cabinet
- 02** GGD柜
GGD Cabinet
- 03** 光伏并网柜
Photovoltaic (PV)
Grid-Connected Cabinet
- 04** 不锈钢并网箱
Stainless Steel
Grid-Connected Cabinet
- 05** 仿威图柜
Rittal-Style Cabinet
- 06** JXF基业箱
JXF Foundation Box
- 07** 不锈钢明/暗配电箱
Stainless Steel
Surface-Mounted/Recessed
Distribution Box
- 08** 不锈钢户外配电箱
Stainless Steel Outdoor
Distribution Box
- 09** 不锈钢户外动力柜
Stainless Steel Outdoor
Power Cabinet
- 10** 不锈钢三开门电表箱
Stainless Steel Three-Door
Electric Meter Cabinet
- 11** Jp综合配电柜
JP Integrated
Power Distribution Cabinet
- 12** 户外工地箱
Outdoor Construction
Site Cabinet



XL-21 Power Cabinet

XL-21 动力柜



产品概述 Product Overview

- ① 采用喷塑冷轧钢板箱体，坚固耐用防腐防锈。
- ② 柜体下方多孔散热，快速降温。
- ③ 门板上有加固条，增加强杠，长久使用不变形。
- ④ 可调节横梁，可根据需求上下调节。
- ⑤ 搭配高质量锁芯和高强度铰链，不易损坏。
- ⑥ 适用场景：室内、室外。
- ⑦ 支持非标定制，可开孔、可印字、可指定元器件品牌进行成套定制。
- ⑧ Adopts a spray-coated cold-rolled steel cabinet, featuring sturdiness, durability, corrosion resistance and rust prevention.
- ⑨ Multi-hole heat dissipation design at the bottom of the cabinet ensures rapid cooling.
- ⑩ Reinforcement bars are equipped on the door panel to enhance structural rigidity, preventing deformation even after long-term use.
- ⑪ Adjustable crossbeams, which can be moved up and down according to specific needs.
- ⑫ Equipped with high-quality lock cylinders and high-strength hinges, offering excellent resistance to damage.
- ⑬ Application scenarios: Indoor and outdoor.
- ⑭ Supports non-standard customization, including hole drilling, logo/character printing, and complete set customization with specified component brands.

外形尺寸 Overall Dimensions

型号 Model	宽 Wide(W)	高 High(H)	深 Deep(E)
XL-21	600	1200	370
XL-21	700	1500	370
XL-21	700	1700	370
XL-21	800	1800	400



GGD Cabinet

GGD 柜



产品概述 Product Overview

- ① 采用喷塑冷轧钢板箱体，坚固耐用防腐防锈。
- ② 柜体下方多孔散热，快速降温。
- ③ 搭配高质量锁芯和高强度铰链，不易损坏。
- ④ 支持非标定制，可开孔、可印字、可指定元器件品牌进行成套定制。
- ⑤ It adopts a spray-coated cold-rolled steel plate cabinet, which is sturdy, durable, anti-corrosive and anti-rust.
- ⑥ The lower part of the cabinet is designed with multiple holes for heat dissipation, enabling rapid cooling.
- ⑦ It is equipped with high-quality lock cylinders and high-strength hinges, which are not easy to be damaged.
- ⑧ Non-standard customization is supported, including hole drilling, letter printing, and complete-set customization with specified component brands.

外形尺寸 Overall Dimensions

型号 Model	宽 Wide(W)	高 High(H)	深 Deep(D)
GGD 柜	600	2200	600
GGD 柜	800	2200	600
GGD 柜	1000	2200	600
GGD 柜	1200	2200	600
GGD 柜	600	2200	800
GGD 柜	800	2200	800
GGD 柜	1000	2200	800
GGD 柜	1200	2200	800



Photovoltaic (PV) Grid-Connected Cabinet

光伏并网柜



产品概述 Product Overview

- ① 采用喷塑冷轧钢板箱体，坚固耐用防腐防锈。
- ② 柜体下方多孔散热，快速降温。
- ③ 门板上有加固条，增加强杠，长久使用不变形。
- ④ 搭配高质量锁芯和高强度铰链，不易损坏。
- ⑤ 可拆卸安装板，方便电气元件安装方便，拆装简单。
- ⑥ 适用场景：室内、室外。
- ⑦ 支持非标定制，可开孔、可印字、可指定元器件品牌进行成套定制。
- ⑧ It adopts a spray-coated cold-rolled steel plate cabinet, which is sturdy, durable, anti-corrosive and anti-rust.
- ⑨ The lower part of the cabinet is designed with multiple holes for heat dissipation, enabling rapid cooling.
- ⑩ The door panel is equipped with reinforcing strips to enhance its structural strength, ensuring no deformation even with long-term use.
- ⑪ It is fitted with high-quality lock cylinders and high-strength hinges, which are resistant to damage.
- ⑫ The detachable mounting plate facilitates the installation of electrical components, making assembly and disassembly simple.
- ⑬ Applicable scenarios: indoor and outdoor.
- ⑭ Non-standard customization is supported, including hole drilling, letter printing, and complete-set customization with specified component brands.

外形尺寸 Overall Dimensions

型号 Model	宽 Wide(W)	高 High(H)	深 Deep(E)
BWG 200-400KW	800	2200	800
BWG 400-1000KW	1000	2200	1000

Stainless Steel Grid-Connected Cabinet

不锈钢并网箱



产品概述 Product Overview

- ④ 采用 201/304 不锈钢箱体，内置密封条防水防雨防尘。
- ④ 侧边多孔散热，有效降温。
- ④ 双坡型防雨帽。
- ④ 箱内配有可拆卸安装底板，可挂载各种电器设备。
- ④ 适用场景：室内、室外。
- ④ 支持非标定制、可开孔、可印字、可指定元器件品牌进行成套定制。
- ④ It adopts a 201/304 stainless steel cabinet, with built-in sealing strips to provide protection against water, rain and dust.
- ④ There are multiple holes on the side for heat dissipation, which effectively reduces the temperature.
- ④ It is equipped with a double-slope rain cap.
- ④ The cabinet comes with a detachable mounting base plate, on which various electrical equipment can be mounted.
- ④ Application scenarios: Indoor and outdoor.
- ④ It supports non-standard customization, including hole drilling, printing, and complete-set customization with specified component brands.

外形尺寸 Overall Dimensions

型号 Model	宽 Wide(W)	高 High(H)	深 Deep(E)
BWX-507518	500	750	180
BWX-609018	600	900	180
BWX-7010018	700	1000	180



Rittal-style cabinet

仿威图柜



产品概述 Product Overview

- ① 采用喷塑冷轧钢板箱体，内置密封条防水防尘。
- ② 可拆卸安装板，方便电气元件安装方便，拆装简单。
- ③ 搭配高质量锁芯和高强度铰链，不易损坏。
- ④ 适用场景：室内、室外。
- ⑤ 支持非标定制，可开孔、可印字、可指定元器件品牌进行成套定制。
- ⑥ It adopts a spray-coated cold-rolled steel plate cabinet, with built-in sealing strips for water, rain and dust resistance.
- ⑦ The detachable mounting plate facilitates the installation of electrical components, enabling simple assembly and disassembly.
- ⑧ It is equipped with high-quality lock cylinders and high-strength hinges, which are not easy to be damaged.
- ⑨ Applicable scenarios: indoor and outdoor.
- ⑩ Non-standard customization is supported, including hole drilling, letter printing, and complete-set customization with specified component brands.

外形尺寸 Overall Dimensions

型号 Model	宽 Wide(W)	高 High(H)	深 Deep(E)
WT-ES 五折柜	600	1200	400
	600	1600	400
	700	1700	400
	800	1800	400
	800	1800	600
	800	2000	600
WT-PS 九折柜	800	1800	600
	1000	1800	600
	1200	1800	600
	800	2000	600
	1000	2000	600
	1200	2000	600



JXF Foundation Box

JXF 基业箱

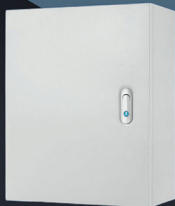

产品概述 Product Overview



- ④ 采用喷塑冷轧钢板箱体，内置密封条防水防尘。
- ④ 箱内配有可拆卸安装底板，可挂载各种电气设备。
- ④ 适用场景：室内、室外。
- ④ 支持非标定制，可开孔、可印字、可指定元器件品牌进行成套定制。
- ④ It adopts a spray-coated cold-rolled steel plate cabinet, with a built-in sealing strip for water, rain and dust resistance.
- ④ The cabinet is equipped with a detachable mounting base plate, which can be used to mount various electrical equipment.
- ④ Applicable scenarios: indoor and outdoor.
- ④ Non-standard customization is supported, including hole drilling, letter printing, and complete-set customization with specified component brands.



外形尺寸 Overall Dimensions

型号 Model	宽 Wide(W)	高 High(H)	深 Deep(D)
JXF-253015	250	300	150
JXF-304020	300	400	200
JXF-405020	400	500	200
JXF-406020	400	600	200
JXF-506020	500	600	200
JXF-507020	500	700	200
JXF-608020	600	800	200
JXF-8010020	800	1000	200
JXF-506025	500	600	250
JXF-608025	600	800	250
JXF-8010025	800	1000	250



Stainless Steel Surface-Mounted/Recessed Distribution Box

不锈钢明 / 暗配电箱



产品概述 Product Overview

- ④ 采用 201/304 不锈钢箱体，内置密封条防水防雨防尘。
- ④ 箱内配有可拆卸安装底板，可挂载各种电器设备。
- ④ 适用场景：室内。
- ④ 支持非标定制，可开孔、可印字、可指定元器件品牌进行成套定制。
- ④ It adopts a 201/304 stainless steel cabinet, with built-in sealing strips for water, rain and dust resistance.
- ④ The cabinet is equipped with a detachable mounting base plate, which can be used to mount various electrical equipment.
- ④ Applicable scenarios: indoor.
- ④ Non-standard customization is supported, including hole drilling, letter printing, and complete-set customization with specified component brands.

外形尺寸 Overall Dimensions

型号 Model	宽 Wide(W)	高 High(H)	深 Deep(E)
JXFS-253016	250	300	160
JXFS-304018	300	400	180
JXFS-405018	400	500	180
JXFS-506020	500	600	200
JXFS-608020	600	800	200
JXFS-8010020	800	1000	200

注：暗装比明装深度浅 2 公分

Stainless Steel Outdoor Distribution Box

不锈钢户外配电箱



产品概述 Product Overview

- 采用 201/304 不锈钢箱体，内置密封条防水防雨防尘。
- 箱内配有可拆卸安装底板，可挂载各种电器设备。
- 适用场景：室内。
- 支持非标定制，可开孔、可印字、可指定元器件品牌进行成套定制。
- It adopts a 201/304 stainless steel cabinet, with built-in sealing strips for water, rain and dust resistance.
- The cabinet is equipped with a detachable mounting base plate, which can be used to mount various electrical equipment.
- Applicable scenarios: indoor.
- Non-standard customization is supported, including hole drilling, letter printing, and complete-set customization with specified component brands.

外形尺寸 Overall Dimensions

型号 Model	宽 Wide(W)	高 High(H)	深 Deep(E)
JXFSH-302516	300	250	160
JXFSH-403018	400	300	180
JXFSH-504018	500	400	180
JXFSH-605018	600	500	180
JXFSH-705020	700	500	200
JXFSH-806020	800	600	200
JXFSH-806025	800	600	250
JXFSH-1008020	1000	800	200

注：暗装比明装深度浅 2 公分

Stainless Steel Outdoor Power Cabinet

不锈钢户外动力柜



产品概述 Product Overview

- ④ 采用 201/304 不锈钢箱体，内置密封条防水防雨防尘。
- ④ 侧边多孔散热，有效降温。
- ④ 双坡型防雨帽。
- ④ 箱内配有可拆卸安装底板，可挂载各种电器设备。
- ④ 适用场景：室外。
- ④ 支持非标定制、可开孔、可印字、可指定元器件品牌进行成套定制。
- ④ Adopts 201/304 stainless steel cabinet, with built-in sealing strips for water, rain and dust resistance.
- ④ Multi-hole heat dissipation on the side for effective cooling.
- ④ Double-slope rain cap.
- ④ The cabinet is equipped with a detachable mounting base plate, which can be used to mount various electrical equipment.
- ④ Application scenario: Outdoor.
- ④ Supports non-standard customization, including hole drilling, printing, and complete-set customization with specified component brands.

外形尺寸 Overall Dimensions

型号 Model	宽 Wide(W)	高 High(H)	深 Deep(E)
XLSH-6010035	600	1000	350
XLSH-8010025	800	1000	250
XLSH-6012035	600	1200	350
XLSH-7015037	700	1500	370
XLSH-7017037	700	1700	370
XLSH-8018040	800	1800	400

Stainless Steel Three-Door Electric Meter Cabinet

不锈钢三开门电表箱



产品概述 Product Overview

- ④ 采用 201/304 不锈钢箱体，内置密封条防水防雨防尘。
- ④ 侧边多孔散热，有效降温。
- ④ 双坡型防雨帽。
- ④ 箱内配有可拆卸安装底板，可挂载各种电器设备。
- ④ 适用场景：室内、室外。
- ④ 支持非标定制、可开孔、可印字、可指定元器件品牌进行成套定制。
- ④ It features a 201/304 stainless steel cabinet, with built-in sealing strips that provide protection against water, rain, and dust.
- ④ The side panels are designed with multiple holes for heat dissipation, ensuring effective temperature reduction.
- ④ It is equipped with a double-slope rain cap for enhanced weather resistance.
- ④ Inside the cabinet, there is a detachable mounting base plate, which allows for the installation of various electrical equipment.
- ④ Application scenarios: Indoor and outdoor.
- ④ Non-standard customization is supported, including services such as hole drilling, logo printing, and complete-set customization with specified component brands.

外形尺寸 Overall Dimensions

型号 Model	宽 Wide(W)	高 High(H)	深 Deep(E)
三相 4 户	650	800	150
三相 6 户	750	800	150
三相 8 户	900	800	150
三相 10 户	1050	800	150
三相 12 户	900	1050	150
三相 15 户	1050	1050	150
三相 18 户	1200	1050	150

JP Integrated Power Distribution Cabinet

JP 综合配电柜



产品概述 Product Overview

- ④ 采用 201/304 不锈钢箱体，内置密封条防水防雨防尘。
- ④ 侧边多孔散热，有效降温。
- ④ 双坡型防雨帽。
- ④ 箱内配有可拆卸安装底板，可挂载各种电器设备。
- ④ 适用场景：室外。
- ④ 支持非标定制、可开孔、可印字、可指定元器件品牌进行成套定制。
- ④ It adopts a 201/304 stainless steel cabinet, with built-in sealing strips to shield against water, rain and dust.
- ④ The side is designed with multiple holes for heat dissipation, enabling effective temperature reduction.
- ④ It is fitted with a double-slope rain cap.
- ④ Inside the cabinet, a detachable mounting base plate is provided, which can be used to mount various electrical equipment.
- ④ Application scenario: Outdoor.
- ④ It supports non-standard customization, including hole drilling, lettering, and complete-set customization with specified component brands.

外形尺寸 Overall Dimensions

型号 Model	宽 Wide(W)	高 High(H)	深 Deep(E)	变压器容量 Transformer Capacity
JP-657035	650	700	350	50KVA 以下 Below 50 KVA
JP-908050	900	800	500	50-80KVA
JP-1008050	1000	800	500	100-125KVA
JP-1259060	1250	900	600	160-200KVA
JP-1359070	1350	900	700	250-315KVA
JP-1551270	1550	1200	700	500KVA

Outdoor Construction Site Cabinet

户外工地箱



产品概述 Product Overview

- ④ 采用喷塑冷轧钢箱体，内置密封条防水防雨防尘。
- ④ 侧边多孔散热，有效降温。
- ④ 双坡型防雨帽。
- ④ 适用场景：室内、室外。
- ④ 支持非标定制、可开孔、可印字、可指定元器件品牌进行成套定制。
- ④ It adopts a spray-painted cold-rolled steel cabinet, with built-in sealing strips for protection against water, rain and dust.
- ④ The side is designed with multiple holes for heat dissipation, enabling effective temperature reduction.
- ④ It is equipped with a double-slope rain cap.
- ④ Application scenarios: Indoor and outdoor.
- ④ It supports non-standard customization, including hole drilling, printing, and complete-set customization with specified component brands.

外形尺寸 Overall Dimensions

型号 Model	宽 Wide(W)	高 High(H)	深 Deep(E)	
款型：平顶	GD253018	250	300	180
	GD304018	300	400	180
	GD405018	400	500	180
	GD506018	500	600	180
	GD608018	600	800	180
款型：高脚	GD404020	400	400	200
	GD405020	400	500	200
	GD406020	400	600	200
	GD506020	500	600	200
	GD608025	600	800	250
款型：斜顶	GD8010025	800	1000	250
	GD304517	300	450	170
	GD405518	400	550	180
	GD506518	500	650	180
	GD608520	600	850	200
GD8010525	800	1050	250	



速尔科技(浙江)股份有限公司
LYE TECHNOLOGY (ZHEJIANG) CO.,LTD

地址Add: 浙江省温州市洞头区霓盛路1190号
电话Tel: 0577-61710288
Http: //www.cnlye.com

