

**LYE® 莱伊尔**

# ELECTRICAL CABINET MANUFACTURER

电气机柜制造商



Aesthetic  
distribution cabinet

美学配电柜

# “智慧电力”

## 我是您的配电小涑

智联未来

涑伊尔智能电气机柜强大的研发能力  
以及前瞻性的产品工业设计。

让您看见未来的样子...



# "Smart Power" I'am your power distribution xiaolai

Smart Connected Future  
The strong R&D capability of LYE Intelligent  
Electrical Cabinets as well  
as forward-looking industrial design for products  
Let you see what the future looks like



# Beginning with the future Electricity Wisdom

## 始于对未来的 电力智慧



涑伊尔科技（浙江）股份有限公司是一家位于浙江温州的国家高新技术企业，专注于智慧配电箱、弱电箱、高低压柜的研发、生产与销售。公司以打造高品质、智能化配电设备为核心，致力于为客户提供安全、可靠的电力解决方案。

作为中国智能配电箱十大品牌及国家标准起草单位，涑伊尔拥有多项专利技术，产品通过ISO9001、ISO14001、OHSAS18001、CCC、CE、TUV等多项国内外权威认证，品质达国际先进水平。

公司已成为世界500强及行业龙头企业的优选供应商，市场占有率与客户满意度持续提升。涑伊尔以“成为中国智能电箱领导者”为愿景，秉持“合作、共享、利他、成长”的价值观，持续推动产品智能化与技术革新。

未来，涑伊尔将持续加大研发投入，积极拓展海内外市场，不断提升产品与服务，实现可持续高质量发展。



**愿景Vision:**

**致力于成为中国电气机柜领域引领者**  
Dedicated to becoming a leader in China's electrical cabinet industry

**使命Mission:**

**让电更安全、更智能**  
Make electricity safer and smarter

**价值观Values:**

**合作、共享、利他、成长**  
Cooperation, sharing, altruism, growth

LYE Technology (Zhejiang) Co., Ltd. is a national high-tech enterprise located in Wenzhou, Zhejiang Province, specializing in the R&D, production and sales of smart power distribution boxes, low-voltage distribution boxes, and high-low voltage cabinets. With the core goal of creating high-quality and intelligent power distribution equipment, the company is committed to providing customers with safe and reliable power solutions.

As one of the Top 10 Brands of China's Smart Power Distribution Boxes and a drafter of national standards, LYE holds a number of patented technologies. Its products have obtained multiple authoritative certifications at home and abroad, including ISO9001, ISO14001, OHSAS18001, CCC, CE, and TUV, and their quality has reached the international advanced level.

The company has become a preferred supplier for Fortune Global 500 companies and industry leaders, with its market share and customer satisfaction continuing to rise. LYE takes "becoming a leader in China's smart power distribution boxes" as its vision and adheres to the values of "Cooperation, Sharing, Altruism, and Growth" to continuously promote product intelligence and technological innovation.

In the future, LYE will continue to increase R&D investment, actively expand domestic and overseas markets, constantly improve its products and services, and achieve sustainable and high-quality development.

# 智能制造加工中心

智能加工中心引进了德国通快技术的钣金智能柔性加工生产线、智能数控冲床分拣中心、ABB机器人智能折弯中心、ABB机器人激光焊接中心、智能激光切割分拣中心、RGV智能成套装配生产线、智能母排数控中心、MES系统等先进的工艺流程及检测设备。



▲ 智能母排数控中心



▲ ABB机器人激光焊接中心



▲ 智能柔性加工生产线

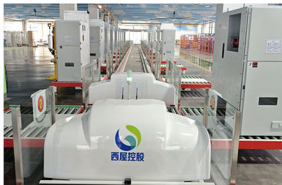

▲ RGV智能成套装配生产线



▲ 机器人智能折弯中心



▲ 数控折弯机

# Intelligent manufacturing processing center

The Intelligent Processing Centre has introduced advanced processes and testing equipment such as intelligent flexible processing production line for sheet metal, intelligent CNC punching sorting centre, ABB robot laser welding centre, intelligent laser cutting sorting centre, RGV intelligent complete assembly production line, intelligent CNC centre for busbars and MES system, etc., which are based on the technology of Germany Tongxu.



▲ 智能激光切割分拣中心



▲ 雷电冲击试验装置



▲ 局放电磁屏蔽室



▲ 无局放耐压试验装置



▲ 全自动热缩加工中心



▲ 全自动二次线加工中心

# INNOVATION LEADS THE FUTURE

## 创新引领未来



The company has passed the certification of ISO 9001 quality management system, ISO 14001 environmental management system and ISO 45001 Occupational health and safety management system, and its core products have obtained the National Grid standard certification and EU CE and other international qualifications. Its independent research and development of submerged liquid cooling charging pile technology (energy efficiency of 97.6%) has 1 invention patent and a number of utility model patents, and cooperation with "Jingong Electric" to achieve market breakthroughs, to solve the pain points of the supercharge industry.



公司通过ISO 9001质量管理体系、ISO 14001环境管理体系及ISO 45001职业健康安全管理体系认证，核心产品获国家电网标准认证及欧盟CE等国际资质。其自主研发的浸没液冷充电桩技术（能效达97.6%）拥有16项发明专利及多项实用新型专利，并与“京工电”合作实现市场化突破，解决了超充堆行业痛点。



Continue to deepen  
environmental protection and  
intelligent technology,  
Making power equipment safer

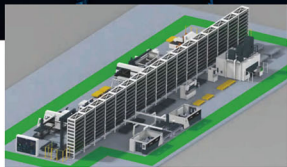

▲ 钣金自动化生产线



The company has obtained ISO 9001 Quality Management System, ISO 14001 Environmental Management System, and ISO 45001 Occupational Health and Safety Management System certifications, ensuring that its products meet international standards. Its core products have received State Grid Standard Certification and EU CE Certification, showcasing exceptional quality and safety.

The company holds multiple invention patents and utility model patents and continues to drive advancements in switchgear technology, striving to deliver safer, more efficient, and smarter power solutions.

**LYE® 深伊尔** 电气机柜制造商  
Electrical cabinet manufacturer

致力于智能电气机柜设备的研发制造，  
让电网系统更安全！更可靠！更智能！护航零碳未来！

Dedicated to the research and manufacturing  
of intelligent electrical cabinet equipment,  
Make the power grid system safer! More reliable!  
More intelligent! Escort a zero carbon future!

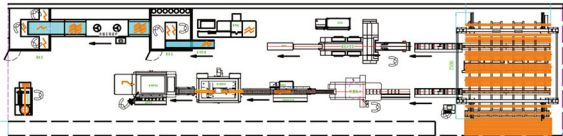

▲ 母排自动化生产线

技术中心作为公司新产品研究与开发的中枢，具备完善的研究与开发的能力。创新进取精神是一个企业发展的永恒动力，西屋控股将永远支持创新精神，永不安于现状。企业将在完善现有产品基础上，不断创新生产技术，发展各种优质的新产品以适合市场需要，增强企业的核心竞争力。



Future Energy Efficiency World,  
We advocate for  
sustainable development.

**未来能效世界，  
我们倡导可持续发展。**

# 产品目录

## Product Catalog

- |    |   |    |  |
|----|---|----|--|
| 01 | SH-B柜<br>Low voltage switch cabinet           | 25 | KYN28-12<br>金属铠装移开式开关柜(国网型)<br>Metal armored movable switchgear (national grid type)   |
| 03 | SH-8PT低压开关柜<br>Low-voltage switch cabinet     | 27 | KYN28-12<br>金属铠装高低中置移开式开关柜<br>Metal armor high and low mid-mounted removable switchgear  |
| 05 | SLVA低压标准化柜(国网柜)<br>Standardized cabinet       | 29 | KYN61-40.5<br>铠装移开式交流金属封闭开关柜<br>Armored removable AC metal enclosed switchgear   |
| 07 | MNS0.4kV低压开关柜<br>Low-voltage switch cabinet   | 31 | 落地式直流充电桩<br>60/80/120/160kw 单双枪<br>Floor type Dc charging pile<br>60/80/120/160kwsingle and double gun   |
| 09 | GCS0.4kV低压开关柜<br>Low-voltage switch cabinet   | 33 | 14kW<br>落地式单双枪交流充电桩<br>Floor type single and double gun AC charging pile   |
| 11 | GCK0.4kV低压开关柜<br>Low-voltage switch cabinet   | 35 | 7kW<br>壁挂式电动汽车交流充电桩<br>Wal-mounted electric AC charging pile   |
| 13 | GGD柜<br>GGD cabinet                           | 37 | WHDCC-A系列<br>落地式第三代直流充电桩<br>60/80/120/160/180/240kw单双枪<br>WHDCC-A series floor type<br>pethird generation DC charging pile<br>60/80/120/160/180/240kwsingle and double gun |
| 15 | SFRM16-12充气柜<br>Switch cabinet                |    |  |
| 17 | YXRM-40.5充气柜<br>Switch cabinet                |    |  |
| 19 | XGN15-12环网柜<br>Ring network cabinet           |    |  |
| 21 | GTXGN-12/V固体柜<br>Solid cabinet                |    |  |
| 23 | HXGN66-12高压开关柜<br>High voltage switch cabinet |    |  |

# SH-B柜

switch cabinet

低压开关柜



# SH-B柜 低压开关柜

## Low voltage switch cabinet

### 概述

SH-B 柜系列开关柜(简称B柜),是低压配电产品,符合IEC60439-1、IEC60529、IEC60947等相关标准,可作为动力配电中心、电动机控制中心、电容补偿及终端配电等电能控制,转换与分配设备使用。适用于发电厂、变电站、工矿企业、民用建筑基础设施、水处理、机场、港口等各个领域。

### Summary

SH-B cabinet series switchgear (referred to as B cabinet) is a low-voltage power distribution product, which meets IEC60439-1, IEC60529, IEC60947 and other relevant standards, and can be used as power distribution center, motor control center, capacitance compensation and terminal power distribution and other power control, conversion and distribution equipment. It is suitable for power plants, substations, industrial and mining enterprises, civil building infrastructure, water treatment, airports, ports and other fields.

### 产品优势

- a. 模块化结构, 模块化系统, 标准化元件;
- b. 功能性的设计, 合理化的尺寸和内部布置, 减少占地面积, 简便的主电路和辅助电路连接, 易于安装, 升级成本得以控制;
- c. 高水平的可靠性和安全性, 加强对人身和设备安全的保护;

### Product advantages

- a. Modular structure, modular system, standardized components;
- b. Functional design, rational size and interior layout, reduce the footprint, simple main
- Circuits and auxiliary circuits are connected, easy to install, and upgrade costs are controlled;
- c. High level of reliability and safety, strengthening the protection of personal and equipment safety.

### 技术参数

额定绝缘电压: 1000 V(A C)  
 额定运行电压: 690V(A C)  
 额定冲击耐受电压: 12kV  
 额定短时耐受电流: 100kA\*1s  
 额定峰值耐受电流: 220kA  
 过压类别: IV  
 主母线额定电流: 6300A  
 分隔类型: 1/2b/3b/4  
 防护等级: IP30/31/40/42/55  
 功能单元形式: 固定式, 抽出式

### Technical parameter

Rated Insulation Voltage: 1000 V (A C)  
 Rated Operating Voltage: 690V(A C)  
 Rated Shock Withstand Voltage: 12kV  
 Rated short-term withstand current: 100kA\*1s  
 Rated Peak Withstand Current: 220kA  
 Overvoltage category: IV  
 Main bus rated current: 6300A  
 Separation Type: 1/2b/3b/4  
 Degree of protection: IP30/31/40/42/55  
 Functional unit form: fixed type, extraction type

### 产品特点

- SH-B 柜的标志如下所列的四个特点, 可被看作是SH-B 柜的标志
- a. 通风挡板的标准颜色为RAL 7016;
  - b. 标识必须与功能单元门把手位置对齐;
  - c. 柜壳金属部件的标准颜色为RAL 9002, 该颜色用户可修改;
  - d. 门锁的颜色与标识、通风挡板和把手一致;

### Product features

- SH-B cabinet logo  
 The four features listed below can be regarded as the hallmark of the SH-B cabinet
- a. The standard colour of the ventilation baffle is RAL 7016;
  - b. The logo must be aligned with the position of the door handle of the functional unit;
  - c. The standard colour of the metal parts of the cabinet shell is RAL 9002, which can be modified by the user;
  - d. The color of the door lock is consistent with the logo, ventilation baffle and handle;

# SH-8PT

Low-voltage switch  
cabinet

低压开关柜



# SH-8PT 低压开关柜

## Low-voltage switch cabinet

### 概述

SH-8PT是一种授权的新型的低压开关柜，它具有断路器技术、固定安装式技术、抽出式技术及插入式设计；SH-8PT还通过了内燃弧实验和八级地震实验认证。SH-8PT柜骨架采用2.5mm镀锌板，覆铝锌板全螺钉连接或螺栓联接加焊接面拼接实现。立柱纵宽85mm，并打有25mm模数的安装孔。可选择用角连接器保证骨架三方向连接，后柜可加装三角支撑架加强骨架强度。柜相时接触面较宽，整体的配合良好。

SH-8PT的固定分隔柜型有灵活多变的水平母线系统，柜门特有的压力释放通道有效的保障故障时的人身安全；柜门开启角度可至180度。柜门带防下坠装置，旋转弹簧锁能可靠防止由于疏忽或意外而使门弹开，可工厂化批量生产。

### Summary

SH-8PT is an authorized new type of low-voltage switchgear, which has circuit breaker technology, fixed installation technology, extraction technology and plug-in technology design. The SH-8PT has also been certified for internal combustion arc experiments and magnitude 8 seismic tests. The skeleton of the SH-8PT cabinet is realized by 2.5mm galvanized plate, galvanized cab-clad plate fully screwed or bolted and welded hybrid splicing. The column is 85mm wide and has a mounting hole of 25mm modulus. You can choose to use corner connectors to ensure the three-way connection of the skeleton, and the rear cabinet can be equipped with a triangular support frame to strengthen the strength of the skeleton. The contact surface is wide when consolidating cabinets, and the overall cooperation is good. The fixed partition cabinet type of SH-8PT has a flexible horizontal busbar system, and the unique pressure release channel on the top of the cabinet effectively ensures personal safety in case of fault. The cabinet door can be opened at an angle of up to 180 degrees. The cabinet door with anti-sag device and the swing handle spring lock can reliably prevent the door from being bounced open due to negligence or accident, and can be mass-produced in the factory.

### 技术参数

额定绝缘电压: 1000V(A C)	过压类别: III
额定运行电压: 690V(A C)	主母线额定电流: 7400A
额定冲击耐受电压: 8kV	防护等级: IP30/31/40/41/42/54
额定短时耐受电流: 100kA*1s	功能单元形式: 固定式、抽出式
额定峰值耐受电流: 375kA	

### Technical parameter

Rated Insulation Voltage: 1000V(A C)
Rated Operating Voltage: 690V(A C)
Rated Shock Withstand Voltage: 8kV
Rated short-term front current received: 100kA*1s
Rated Peak Withstand Current: 375kA
Overvoltage Category: III
Main bus rated current: 7400A
Degree of protection: IP30/31/40/41/42/54
Functional unit form: fixed type, extraction type

### 产品优势与特点

1. 每台SH-8PT开关设备全部采用优质的西门子开关电器和其它公司的优质开关电器器件，保证其使用寿命长和运行可靠性高。
2. 通过型式试验(TTA)的低压配电装置安全、灵活多样。
3. 骨架和外壳尺寸精准，结构牢固；它有二种结构型式，即螺钉连接或焊接式。柜门装有释压装置。
4. 灵活多变的水平母线系统满足不同的适用要求，水平母线统一布设在开关柜的上方
5. 断路器技术结构紧凑，安全可靠。
6. 固定安装式技术经济、安全、适应性好。
7. 3级和4级水平母线系统其额定电流可至7400A
8. 额定峰值耐受电流可至375kA
9. 器件隔室的深度尺寸大，适用于各种安装
10. 器件隔室可按模数结构分隔成不同的单元(符合IEC 60439-1规定的形式1至形式4)
11. 开关柜可单面安装，也可背背背安装
12. 进线可采用上进线或下进线
13. 出线电缆可在柜体前部连接或后部连接
14. 特殊设计的铰链能保证柜门时的更大开启角度为180°，并柜时大于140°

### Product advantages and characteristics

1. Each SH-8PT switchgear adopts high-quality Siemens switchgear and high-quality switchgear from other companies to ensure its long service life and high operating reliability.
2. Low-voltage power distribution devices that have passed the type test (TTA) are safe, flexible and diverse.
3. The skeleton and shell are accurate in size and firm in structure; It has two types of structure, namely screw connection type or welded type. The top of the cabinet is equipped with a pressure relief device.
4. The flexible horizontal bus system meets different applicable requirements, and the horizontal bus is uniformly arranged above the switch cabinet
5. Circuit breaker technology is compact, safe and reliable.
6. The fixed installation type is economical, safe and adaptable.
7. Class 3 and Class 4 horizontal bus systems are rated up to 7400A
8. The rated peak withstand current can be up to 375kA
9. The depth size of the device compartment is large, suitable for various installations
10. The device compartment can be divided into different units according to the analog-digital structure (form 1 to form 4 according to IEC 60439-1)
11. The switch cabinet can be installed on one side or back-to-back
12. The incoming line can be used as an upper or lower inlet line
13. The outlet cable can be connected at the front or rear of the cabinet
14. The specially designed hinge can ensure that the larger opening angle of the door is 180° when the cabinet is single, and more than 140° when the cabinet is combined

# SLVA

Standardized cabinet

低压标准化柜（国网柜）





# SLVA 低压标准化柜(国网柜)

## Standardized cabinet

### 概述

高低压开关柜是目前配电网应用量最大、面最广的主流设备。由于制造企业分散、产品质量参差不齐，设备标准化已是大势所趋。为进一步落实“安全可靠、坚固耐用、标准统一、通用互换、合理分级、广泛适用”的设计原则，国家电网有限公司在《国家电网公司配电网工程典型设计(2016年版)》《国家电网公司物资采购标准》等的要求基础上，于2019年7月组织编制了《12kV手车式开关变电站标准化设计定制方案》《低压开关柜标准化设计定制方案》，为设备的标准化工作提供了范本。我公司根据该标准设计标准化柜体，并通过CQC检验国家电网认可的标准化柜体。

### Summary

High and low voltage switchgear is currently the most widely used mainstream equipment in the distribution network, due to the dispersion of manufacturing enterprises and uneven product quality, equipment standardization has become the general trend. In order to further implement the design principles of "safe, reliable, robust and durable, unified standards, universal interchangeability, reasonable grading, and wide application", State Grid Corporation of China organized the compilation of the "12kV Handcart Switching Substation Standardized Design and Customization Plan" and "Low-voltage Switchgear Standardized Design and Customization Plan" in July 2019 on the basis of the requirements of "Typical Design of Distribution Network Engineering of State Grid Corporation of China (2016 Edition)" and "State Grid Corporation of China Material Procurement Standards". It provides a template for the standardization of equipment. Our company designs standardized cabinets according to this standard, and passes CQC inspection of standardized cabinets recognized by the State Grid.

### 结构特点

低压标准化柜高度为2200mm(含眉头，但不包括顶部散热板)，眉头与框架齐平柜深800/1000(不含前后门板)。柜体表面采用环氧粉末静电喷涂工艺，低压开关柜可根据柜宽分为通用型和紧凑型两种柜型，需方可根据站房土建设计要求，结合断路器选型、内部结构的特殊要求等实际情况，选用合适的柜宽类型。同一站房内两种柜型不得混用。

柜体高度为2200mm(含眉头，但不包括顶部散热板)

名称	进线柜/母联柜		馈线柜				无功功率补偿柜	
	方案1	方案2	方案3	方案4	方案5	方案6		方案7
通用型柜宽(mm)	1000	1000	800	1000	800	1000		
紧凑型柜宽(mm)	700	900	700					

通风措施：在进线柜正下面部、背面上部、后门下部(左)、后门下部(右)、顶部(IP40专有)及控制柜正下面部、背面上部、背下面部、顶部(IP40专有)均设有通风孔，当柜内电器元件发热后，热气上升，通过上端孔排出，而冷气由下端通风孔补充进柜，使密闭的柜体上下而上形成一个自然通风道达到散热的目的。

### Product features

Low-voltage standardized cabinet: the height is 2200mm (including the eyebrows, but not the top heat dissipation plate), and the eyebrows are level with the frame and the cabinet depth is 800/1000 (excluding the front and rear door panels). The surface of the cabinet adopts epoxy powder electrostatic spraying process, and the low-voltage switchgear can be divided into two cabinet types: universal and compact according to the cabinet width. The demand party can choose the appropriate cabinet width type according to the civil design requirements of the station building, combined with the actual situation such as circuit breaker selection and special requirements of internal structure. The two cabinet types in the same station building shall not be mixed.

Standardize the width and size of the low-voltage switchgear of the cabinet:

name	incoming cabinet	female cabinet	Feeder cabinet				Reactive power compensation cabinet	
	Option 1	Option 2	Option 3	Option 4	Option 5	Option 6	Option 7	Option 8
Universal cabinet width (mm)	1000	1000	800	1000		800	1000	
Compact cabinet width (mm)	700	900	700					

Ventilation measures: Ventilation holes are provided in the lower part of the front of the inlet cabinet, the upper part of the back, the lower part of the back door (left), the lower part of the rear door (right), the top (IP40 exclusive) and the lower part of the front of the control cabinet, the upper part of the back, the lower part of the back, and the top (IP40 exclusive).

# MNS

0.4kv Low-voltage  
switch cabinet

0.4kV低压开关柜



# MNS 0.4kV 低压开关柜

## Low-voltage switch cabinet

### 概述

MNS系列高2200(1±20%)mm;宽1000mm~600mm;深1000mm~600mm;材料类型:金属型结构型式:组装式、抽出式;使用场所:户内外壳防护等级:IP41、IP40;外部机械撞击防护等级:IK10;最大负载容量:进线柜1500kg,控制柜:1500kg;

热功耗能力进线柜:2490W,控制柜:1530W;

本产品的主构架为模数E=25mm的C型钢组装而成,有效高度1800mm设计紧凑、组装灵活,外形美观,经济性好,抽屉有8E/4(200mm\*4)、6E/2(150mm\*2)8E/2(200mm\*2)6E(150mm)、8E(200mm)、12E(300mm)16E(400mm)、24E(600mm)8个规格8E/4、6E/2、8E/2、6E、8E、12E、16E、24E都具有连接、试验、分离位置,并有可靠的机械联锁,8E/4、6E/2、8E/2 转接件采用FZID金属型分路转接单元8E/4、6E/28E/2 抽屉采用手拉式推进机构;6E、8E、抽屉一般都采用手拉式推进机构

12E、16E、24E、抽屉一般都采用手拉式推进机构;

8E/4 最多可装36个回路;6E/2 最多可装24个回路;8E/2最多可装 18个回路;6E 最多可装9个回路;

本产品适用于三相交流频率为50~60Hz,额定工作电压400V(690V)及以下,额定电流为6300A及以下的发、供电系统中,用于动力、配电和电动机集中控制、电容补偿,广泛应用于发电厂、石油、化工、医院、铁路、高速、机场、工矿、建筑等场所。

### Summary

MNS series height 2200 (1±20%) mm; width 1000mm~600mm; Depth 1000mm~600mm; Material Type: Metal Type; Structure type: assembly, extraction; place of use: indoor; Enclosure protection level: IP41, IP40; External mechanical impact protection class IK10. Maximum load capacity: inlet cabinet 1500kg, control cabinet: 1500kg; Thermal power consumption capacity: incoming cabinet: 2490W, control cabinet: 1530W;

The main frame of this product is assembled of C-shaped steel with a modulus E=25mm, with an effective height of 1800mm, compact design, flexible assembly, beautiful appearance, and good economy. The drawers are: 8E/4 (200mm\*4), 6E/2 (150mm\*2) 8E/2 (200mm\*2) 6E (150mm), 8E (200mm), 12E (300mm) 16E (400mm) 24E (600mm) 8 specifications 8E/4, 6E/2, 8E/2, 6E, 8E, 12E, 16E, 24E all have connection, test, separation positions, and reliable mechanical interlocks. 8E/4, 6E/2, 8E/2 adapters adopt FZID metal type split adapter units, 8E/4, 6E/28E/2 drawers adopt hand-pull propulsion mechanism;

6E, 8E, and drawers generally use hand-pulled propulsion mechanisms 12E, 16E, 24E, drawers generally adopt hand-cranked propulsion mechanism, 8E/4 can be installed with up to 36 circuits; 6E/2 Up to 24 loops; 8E/2 Up to 18 loops; 8E Up to 9 loops;

This product is suitable for power generation and power supply systems with a three-phase AC frequency of 50~60Hz, a rated working voltage of 400V (690V) and below, and a rated current of 6300A and below, and is used for power, power distribution and motor centralized control, capacitance compensation. It is widely used in power plants, petroleum, chemical, hospitals, railways, highways, airports, industrial and mining, construction and other places.

### 结构特点

本低压成套开关柜柜体主要由柜体、框架、支撑梁、主电路连接件1/4单元转接件、1/2单元转接件、母线夹、母线框、绝缘子、铜排等组成。柜体采用冷轧钢板,浅灰色环氧粉末静电喷涂;柜架采用C型钢,支撑梁采用镀锌钢板,经喷塑拼装焊接而成。

壳体外形尺寸(mm):高2200 宽:1000 深:1000(进线柜)高2200 宽:600 深:1000(控制柜)

保护接地措施:整个柜体构成完整的电连续性,防腐性:柜体表面采用浅灰色环氧粉末静电喷涂,内装金属零部件具有防腐能力。

通风措施:在进线柜正面下部、背面上部、后门下(侧),后门下(右)、顶部(IP40专用)及控制柜正面上部、背面上部、背面上部、顶部(IP40专用)均设有通风孔,当柜内电路元件发热后,热气上升,通过上端孔排出,而冷风由下端通风孔孔孔补进,使密闭的柜体自下而上形成一个自然通风道,达到散热的目的。

### Structural features

This low-voltage complete set of switchgear cabinet is mainly composed of cabinet body, cabinet frame, support beam, main circuit connector 1/4 unit adapter, 1/2 unit adapter, busbar clamp, busbar frame, insulator, copper bar, etc. The cabinet is made of cold-rolled steel plate and light gray epoxy powder electrostatic spraying; The cabinet frame is made of C steel, and the support beam is made of aluminum and zinc plate, which is assembled and connected by bolts.

Shell dimensions (mm): Height: 2200 Width: 1000 Depth: 1000 (incoming cabinet) Height: 2200 Width: 600 Depth: 1000 (control cabinet) Protective grounding measures: the entire cabinet constitutes complete electrical continuity.

Anti-corrosion: The surface of the cabinet is electrostatically sprayed with light gray epoxy powder, and the metal parts inside have anti-corrosion ability.

Ventilation measures: Ventilation holes are provided in the lower part of the front of the inlet cabinet, the upper part of the back, the lower part of the back door (left), the lower part of the back door (right), the top (IP40 exclusive) and the lower part of the front of the control cabinet, the upper part of the back, the lower part of the back, and the top (IP40 exclusive).

# GCS

0.4kv Low-voltage  
switch cabinet

0.4kV低压开关柜





## GCS 0.4kV 低压开关柜

### 0.4kV Low-voltage switch cabinet

#### 概述

GCS 系列高 2200 (1 ± 20%) mm; 宽 1000 mm - 600 mm; 深 1000 mm - 600 mm; 材料类型金属结构型式: 组架式, 抽出式;

使用场所户内外壳防护等级: IP41, IP40; 外部机械撞击防护等级: IK10; 最大负载量: 进线柜 1500 kg, 控制柜: 1500 kg; 热功耗能力: 进线柜 2480W, 控制柜: 1510W;

结构特点: 本低压成套开关柜柜体主要由柜体、框架、支撑梁、主电路接插件、1/2 单元转接件、母线夹、母线框、绝缘子、铜排等组成。柜体采用冷轧钢板浅灰色环氧粉末静电喷涂; 柜架采用 C 型钢支撑梁采用敷铝锌板, 经螺栓拼装焊接而成。

壳体外形尺寸 (mm): 高: 2200 宽: 1000 深: 1000 (进线柜) 高: 2200 宽: 600 深: 1000 (控制柜)

保护接地措施: 整个柜体构成完整的电连续性。

防腐性: 柜体表面采用浅灰色环氧粉末静电喷涂; 内装金属等部件具有防腐蚀性。

通风措施: 在进线柜正面下部、背面上部、后门下部 (左)、后门下部 (右)、顶部 (IP40 专用) 及控制柜正面下部、背面上部、背面上部顶部 (IP40 专用) 均设有通风孔, 当柜内电器元件发热后, 热气上升, 通过上端孔排出, 而冷气由下端通风孔补充进柜, 使密闭的柜体自下而上形成一个自然通风道, 达到散热的目的。

本产品的主构架为模数 E = 20 mm 的 C 型钢组装而成, 有效高度 1760 mm 设计紧凑, 组装灵活, 外形美观, 经济性好。抽屉有 8E/2 (160mm\*2)、8E (160mm)、12E (240mm) 16E (320mm)、24E (480mm) 5 个规格。

8E/2、8E、12E、16E、24E 都具有连接、试验、分离位置并有可靠的机械联锁

8/2 转接件采用 FZID 金属型分路转接单元

8E/2 抽屉采用手拉式推进机构;

8E、抽屉一般采用手拉式推进机构; 12E、16E、24E、抽屉一般均采用手推式推进机构;

8E/2 最多可装 22 个回路; 8E 最多可装 11 个回路;

本产品适用于三相交流频率为 50-60Hz, 额定工作电压 400V (690V) 及以下, 额定电流为 6300A 及以下的发电、供电系统中; 用于动力、配电和电动机集中控制、电容补偿。

广泛应用于发电厂、石油、化工、医院、铁路、高速、机场工矿、建筑等场所

#### Summary

GCS series height 2200 (1 ± 20%) mm; width 1000 mm - 600 mm; Depth 1000 mm - 600 mm; Material Type: Metal Type; Structure type: assembly, extraction; Place of use: indoor; Enclosure protection level: IP41, IP40; External mechanical impact protection class IK10; Maximum load capacity: inlet cabinet 1500kg, control cabinet: 1500kg; Thermal power consumption capacity: inlet cabinet: 2480W, control cabinet: 1510W;

Structural characteristics: This low-voltage complete set of switchgear cabinet is mainly composed of cabinet body, cabinet frame, support beam, main circuit connector, 1/2 unit adapter, busbar clamp, busbar frame, insulator, copper bar, etc. The cabinet is made of cold-rolled steel plate, and the light gray epoxy powder is not electrostatically sprayed; The cabinet frame is made of C-shaped steel, and the support beam is made of aluminum-zinc plate, which is assembled and connected by bolts.

Housing Dimensions (mm): Height: 2200 Width: 1000 Depth: 1000 (Inlet Cabinet) Height: 2200 Width: 600 Depth: 1000 (Control Cabinet) Protective grounding measures: The entire cabinet constitutes complete electrical continuity.

Anti-corrosion: The surface of the cabinet is electrostatically sprayed with light gray epoxy powder, and the metal parts inside have anti-corrosion ability. Ventilation measures: in the lower part of the front of the inlet cabinet, the upper part of the back, the lower part of the back door (left), and the lower part of the back door (right), top (IP40 exclusive) and the lower part of the front of the control cabinet, the upper part of the back, and the top of the lower part of the back (IP40 exclusive) are equipped with ventilation holes, when the electrical components in the cabinet heat up, the hot air rises and is discharged through the upper hole, and the cold air is supplemented by the lower vent hole into the cabinet, so that the closed cabinet forms a natural ventilation channel from the bottom up to achieve the purpose of heat dissipation.

The main frame of this product is assembled of C-beam with modulus E=20mm, with an effective height of 1760mm, compact design, flexible assembly, beautiful appearance, and good economy. The drawers are available in 5 specifications: 8E/2 (160mm\*2), 8E (160mm), 12E (240mm), 16E (320mm), and 24E (480mm). The 8E/2, 8E, 12E, 16E, and 24E all have connection, test, and disconnect positions and reliable mechanical interlocks

The 8/2 adapter adopts an FZID metal type split adapter unit 8E/2 drawer adopts hand-pull propulsion mechanism; 8E Drawers generally use hand-pulled propulsion mechanisms, 12E, 16E, 24E, drawers generally use hand-cranked propulsion mechanisms;

8E/2 can be installed with up to 22 circuits; The 8E can be installed with up to 11 circuits; This product is suitable for power generation and power supply systems with a three-phase AC frequency of 50-60Hz, a rated working voltage of 400V (690V) and below, and a rated current of 6300A and below, and is used for power, power distribution and motor centralized control and capacitance compensation. It is widely used in power plants, petroleum, chemical, hospitals, railways, highways, airports, mines, construction, and other places

# GCK

0.4kv Low-voltage  
switch cabinet

0.4kV低压开关柜





Precision  
manufacturing

集成先锋 连接无限

莱伊尔

## GCK 0.4kV低压开关柜

### 0.4kv Low-voltage switch cabinet

#### 概述

本产品的主构架为模数E=25mm的C型钢组装而成，有效高度1800mm设计紧凑，组装灵活，外形美观，经济性好。

抽屉有：

8E/4(200mm\*4)、6/2(150mm\*2)、8E/2(200mm\*2)、6E(150mm)、8E(200mm)、12E(300mm)、16E(400mm)、24E(600mm)8个规格。

8E/4、6E/2、8E/2、6E、8E、12E、16E、24E都具有连接、试验、分离位置，并有可靠的机械联锁。

8E/4、6E/2、8E/2转接件采用FZID金属分路转接单元。

8E/4、6E/2、8E/2抽屉采用手拉式推进机构；

6E、8E、抽屉一般都采用手拉式推进机构；

12E、16E、24E、抽屉一般都采用手推式推进机构；

8E/4最多可装36个回路；6E/2最多可装24个回路；8E/2最多可装18个回路；8E最多可装9个回路；

本产品适用于三相交流频率为50-60Hz，额定工作电压400V(690V)及以下，额定电流为6300A及以下的发、供电系统中，用于动力、配电和电动机集中控制、电容补偿。

广泛应用于发电厂、石油、化工、医院、铁路、高速、机场、工矿、建筑等场所。

#### Summary

The main frame of this product is assembled of C-beam with a modulus E=25mm, with an effective height of 1800mm, compact design, flexible assembly, beautiful appearance, and good economy.

The drawers are: 8E/4 (200mm\*4), 6/2 (150mm\*2), 8E/2 (200mm\*2), 6E (150mm), 8E (200mm), 12E (300mm), 16E (400mm), 24E (600mm) 8 specifications.

8E/4, 6E/2, 8E/2, 6E, 8E, 12E, 16E, 24E all have connection, test, separation positions, and reliable mechanical interlocking.

The 8E/4, 6E/2, and 8E/2 adapters adopt FZID metal split adapter units.

8E/4, 6E/2, 8E/2 drawers adopt hand-pulled propulsion mechanisms;

6E, 8E, and drawers generally adopt hand-pulled propulsion mechanisms;

12E, 16E, 24E, and drawers generally use hand-cranked propulsion mechanisms;

8E/4 can be installed with up to 36 circuits; 6E/2 can be installed with up to 24 circuits; 8E/2 can be installed with up to 18 circuits; 8E can be installed with up to 9 circuits;

This product is suitable for power generation and power supply systems with a three-phase AC frequency of 50-60Hz, a rated working voltage of 400V (690V) and below, and a rated current of 6300A and below, and is used for power, power distribution and motor centralized control, capacitance compensation.

It is widely used in power plants, petroleum, chemical, hospitals, railways, highways, airports, industrial and mining, construction and other places.

# GGD

GGD Cabinet

GGD柜



# GGD柜

## GGD cabinet

### 概述

GGD系列高2200(1+20%)mm;宽800mm~600mm;深600mm~400mm,材料类型-金属型-结构型式-组装式;  
使用场所:户内,外壳防护等级-IP30;外部机械撞击防护等级IK10,最大负载量-1000kg;  
热功耗能力:1250W;  
结构特点:本低压成套开关柜柜体主要由柜体、框架、支撑梁等组成,柜体采用冷轧钢板,浅灰色环氧粉末静电喷涂;框架采用8MF型钢,支撑梁采用敷铝锌板,经螺栓拼装焊接而成。  
壳体外形尺寸(mm):高:2200 宽:800 深:600  
保护接地措施:整个柜体构成完整的电连续性。  
防腐蚀:柜体表面采用浅灰色环氧粉末静电喷涂,内装金属零部件具有防腐蚀能力。  
通风措施:在正面下部、背面上部、背面下部、顶部、底部均设有通风孔,当柜内电器元件发热后,热气上升,通过上端孔排出,而冷风由下端通风孔补充进柜,使密闭的柜体自下而上形成一个自然通风道达到散热的目的。

### Summary

GGD series height 2200 (1 20%) mm; width 800mm~600mm; Depth 600mm~400mm, material type: metal type; Structure type: prefabricated type;  
Place of use: indoor; Enclosure protection level: IP30; External mechanical impact protection class IK10; maximum load capacity: 1000kg;  
Thermal power consumption capability: 1250W;  
Structural characteristics: This low-voltage complete switchgear cabinet is mainly composed of cabinet body, cabinet frame, support beam, etc.  
The cabinet is made of cold-rolled steel plate and light gray epoxy powder electrostatic spraying; The cabinet frame is made of 8MF steel, and the support beam is made of aluminum-zinc plate, which is assembled and connected by bolts.  
Shell dimensions (mm): Height : 2200 Width : 800 Depth : 600  
Protective grounding measures: the entire cabinet constitutes complete electrical continuity.  
Anti-corrosion: The surface of the cabinet is electrostatically sprayed with light gray epoxy powder, and the metal parts inside have anti-corrosion ability.  
Ventilation measures: There are ventilation holes in the upper part of the front, the upper part of the back, the lower part of the back, the top and the bottom.  
The hot air rises and is discharged through the upper hole, while the cold air enters the cabinet through the lower ventilation hole, so that the closed cabinet forms a natural ventilation channel from the bottom up to achieve the purpose of heat dissipation.

# SRM16-12

Inflatable cabinet

环保气体绝缘环网柜



# SRM16-12

## 环保气体绝缘环网柜

### Inflatable cabinet

#### 概述

户内交流高压气体绝缘金属封闭开关设备(以下简称“充气柜”)是新一代开关设备。主开关既可以用永磁机构真空断路器也可以用弹簧机构的真空断路器。整柜采用空气绝缘与六氟化硫气体隔室相结合,既紧凑又可扩充。适用于配电自动化。充气柜具有结构紧凑、操作灵活、联锁可靠等特点,对各种不同的应用场合(特别是环境恶劣的场所,不同的用户要求均能提供令人满意的技术方案。充气柜适用于电力系统的小型二次变电所、开闭所、箱式变电站、住宅小区、工矿企业大型商场,特别适用于机场、地铁、铁路等对用电量要求较高的场合。

#### Summary

Indoor AC high-pressure gas insulated metal enclosed switchgear (hereinafter referred to as "inflatable cabinet") is a new generation of switchgear, the main switch can be used both permanent magnet mechanism vacuum circuit breaker and spring mechanism vacuum circuit breaker, the whole cabinet adopts air insulation and sulfur hexafluoride gas compartment combined, which is both compact and expandable, suitable for power distribution automation. The inflatable cabinet has the characteristics of compact structure, flexible operation, reliable interlocking, etc., and can provide satisfactory technical solutions for various applications (especially in places with harsh environments, different user requirements). The inflatable cabinet is suitable for small secondary substations, switchgear stations, box substations, residential communities, large shopping malls of industrial and mining enterprises, especially for airports, subways, railways and other occasions with high requirements for electricity consumption.

#### 柜体结构

充气隔室采用3MM厚不锈钢板,经数控机床加工后采用焊接机器人焊接而成,焊接变形少,气密性好,其余隔室采用优质冷轧钢板,经数控折弯后焊接而成,具有精度高,强度好的特点。各功能单元均为独立模块,组装极为方便。柜体各密封隔室设有独立的泄压通道,最大限度地保障人身安全和设备运行。

#### Cabinet structure

The inflatable compartment is made of 3MM thick stainless steel plate, which is welded by welding robots after CNC machine tool processing, with less welding deformation and good air tightness, and the rest of the compartment is made of high-quality cold-rolled steel plate, welded by CNC bending, with high precision and good strength. Each functional unit is an independent module, which is extremely easy to assemble. Each sealed compartment of the cabinet is equipped with an independent pressure relief channel to ensure personal safety and equipment operation to the greatest extent.

#### 适用标准

GB/T 11022-2011 《高压开关设备和控制设备标准的共同技术要求》  
GB/T 3906-2006 《3.6kV-40.5kV交流金属封闭开关设备和控制设备》

#### Applicable standards

GB/T 11022-2011 《Common Technical Requirements for High-Voltage Switchgear and Control Equipment Standards》  
GB/T 3906-2006 《3.6kV-40.5kV AC metal enclosed switchgear and control equipment》

#### 防护等级

充气隔离为IP67,低压柜体为IP4X。

#### Protection grade

Inflatable isolation is IP67, The low-voltage cabinet is IP4X.

# YXRM-40.5

Inflatable cabinet

环保气体绝缘开关柜



# YXRM-40.5

## 环保气体绝缘开关柜

### Inflatable cabinet

#### 概述

35KV SF6充气柜充气柜系列高压全封闭全绝缘紧凑型环网开关设备,具备结构紧凑、全封闭式、全绝缘层、寿命长、占有室内空间小、可以信赖、不会受到工作中环境危害等优势,确保了可靠性高、人员安全以及实际上的免维护,可满足不同的供电配置要求,非常适用中小型二次变电所、开闭所、厂矿企业、住宅小区、高速路、地铁站隧道施工等行业。

#### Summary

35KV SF6 inflatable cabinet inflatable cabinet series high-voltage fully enclosed fully insulated compact ring network switchgear, with compact structure, fully enclosed type, full insulation layer, long life, small indoor space, reliable, will not be affected by environmental hazards in work, etc., ensuring high reliability, personnel safety and actual maintenance-free. It can meet different power supply and distribution configuration requirements, and is very suitable for small and medium-sized secondary substations, switching stations, factories and mining enterprises, residential communities, highways, subway stations, tunnel construction and other industries.

#### 结构特点

充气柜采用3mm不锈钢板,不锈钢板由光纤激光切割成型后经焊接机器人焊接而成,焊接变形少,气密性好,具有精度高、强度好的特点;各功能单元均为独立模块,组装极为方便。柜体各密封隔室设有独立的泄压通道,限度地保障人身安全和设备运行。

#### Structural characteristics

The inflatable cabinet is made of 3mm stainless steel plate, which is welded by a welding robot after cutting and forming by fiber laser, with less welding deformation, good air tightness, and the characteristics of high precision and good strength; Each functional unit is an independent module, which is extremely easy to assemble. Each sealed compartment of the cabinet is equipped with an independent pressure relief channel to ensure personal safety and equipment operation to the extent possible.

#### 适用标准

符合国家行业标准:  
GB/T11022-1999、GB3906-2006、GB3804-2004、GB16926-2009、GB/T11023-1999、GB1984-2003、GB1985-2004。

#### Applicable standards

Comply with national industry standards:  
GB/T11022-1999、GB3906-2006、GB3804-2004、GB16926-2009、GB/T11023-1999、GB1984-2003、GB1985-2004。

#### 防护等级

充气隔室防护等级达到IP67, 其余隔室防护等级为IP4X。

#### Protection grade

Inflatable isolation is IP67; The low-voltage cabinet is IP4X.

# GTXGN-12/V

Solid cabinet

固体柜





## GTXGN-12/V固体柜

### Solid cabinet

#### 概述

型单元式环网开关柜，又称六氟化硫柜，柜体采用数控镀锌板经激光切割、数控折弯后铆接而成，比传统企业产品外型更加美观，柜体更加坚固，性能更加稳定。又因SF6环网柜具有体积小，结构简单，具有良好的气密性和可靠性，结构紧凑，所需空间小，免维护，价格合理等特点，深受客户青睐。

#### Summary

The cabinet is made of aluminum and zinc plate by laser cutting, CNC bending and riveting, which is more beautiful than the traditional enterprise products, the cabinet is more sturdy, and the performance is more stable, and because the SF6 ring network cabinet has a small size, simple structure, and good air tightness and reliability. It has the characteristics of compact structure, small space required, maintenance-free, and reasonable price, and is favored by customers.

#### 结构特点

固体绝缘全封闭设备，  
采用模块化、标准化设计，结构紧凑，柜宽375MM，柜体尺寸与SF6环网柜一致，有利于产品升级和现场改造，可实现封闭检修，整体局方不大于10pC

#### Structural characteristics

solid insulation fully enclosed equipment,  
It adopts modular, standardized design, compact structure, cabinet width of 375MM, cabinet size is the same as SF6 ring network cabinet, which is conducive to product upgrading and on-site transformation, can achieve closed maintenance, and the overall local area is not greater than 10pC

#### 技术参数

额定电压 12KV  
额定频率50Hz  
额定电流630/1250A  
额定短路开断电流25/31.5kA  
额定短时耐受电流25/31.5kA  
额定短时峰值耐受电流 63/80KA  
额定短路关合电流 63/80KA  
防护等级：IP4X

#### Technical parameter

Forehead voltage 12KV  
Rated frequency 50Hz  
Rated current 630/1250A  
Rated short-circuit breaking current 25/31.5kA  
It is rated to withstand 25/31.5kA for short periods  
Rated for short-term peak withstand current of 63/80KA  
Rated short-circuit closing current 63/80KA  
protection level: IP4X

# HXGN66-12

High voltage switch  
cabinet

高压开关柜



# HXGN66-12 高压开关柜

## High voltage switch cabinet

### 概述

XGN66-12箱型固定式适用于 3-10KV 三相交流 50Hz 单母线系统中, 作为接受和分配电能只用, 属于新一代小型化城乡电网设备, 具有小型化、结构合理、安全可靠、运行操作简单等特点, 满足市场及城网改造、箱式变电站的需求。

### Summary

XGN66-12 box type fixed type is suitable for 3-10KV three-phase AC 50Hz single bus system, as a receiving and distributing power energy only, belongs to a new generation of miniaturized urban and rural power grid equipment, with the characteristics of miniaturization, reasonable structure, safety and reliability, simple operation and operation, to meet the needs of the market and urban network transformation, box type substation.

### 结构说明

开关柜为金属封闭箱型固定结构, 柜体可以采用C型钢BMF型钢和镀锌锌板材料多种材料制作。经过多种连接件相夹而成。柜体分为四个小室, 即母线室, 仪表室, 断路器室, 电缆室部件全部由剪板机, 机床, 冲床, 折弯机, 全数控先进设备处理加工, 部位尺寸精度高, 制造快捷简便, 便于不同的方案的灵活组合安装, 可满足客户不同的制作要求。

### Structure Description

The switchgear is a metal closed box type fixed structure, and the cabinet can be made of C-shaped steel, BMF steel and aluminum-zinc sheet materials. It is made by a variety of connector groups. The cabinet is divided into four small rooms, namely the busbar room, instrument room, circuit breaker room, cable room components are all processed by shearing machine, machine tool, punching machine, bending machine, full CNC advanced equipment, high shape and dimensional accuracy, fast and easy manufacturing, convenient for flexible combination and installation of different schemes, can meet the different production requirements of customers.

### 主要特点

1. 柜体采用组装式, 无需焊接, 具有较高的机械强度, 优美的外观;
2. 柜上部采用GN30-12旋转式隔离开关, 下部采用 GN19-12G 隔离开关具有按程序操作的机械连锁装置, 为操作人员与设备提供可靠的安全保护。
3. 柜体为空气绝缘, 可配备一体化真空断路器, 固定式 VS1-12(ZN63A)VD4-12 等断路器;
4. 主开关隔离开关及柜门之间均采用强制性机械闭锁方式产品满足五防功能要求;
5. 电缆安装空间大, 便于电缆的制作安装和检测维护
6. 外壳防护等级IP2X,
7. 开关柜门板采用酸洗磷化, 静电喷涂工艺制作, 使其表面具有较强的抗撞击、耐腐蚀、外型美观等特点, 柜体颜色可由用户自定)

### Main features

1. The cabinet adopts assembly type, no welding, with high mechanical strength and beautiful appearance;
2. The upper part of the cabinet adopts GN30-12 rotary disconnect switch, and the lower part adopts GN19-12G disconnect switch it has a mechanical interlock device operated according to the program to provide reliable safety protection for operators and equipment.
3. The cabinet is air insulated, and can be equipped with an integrated vacuum circuit breaker, fixed type VS1-12(ZN63A)VD4-12 and other circuit breakers;
4. The main switch, isolation switch and cabinet door are compulsory mechanical locking methods, and the products meet the requirements of the five prevention functions;
5. The cable installation space is large, which is convenient for cable production, installation, testing and maintenance
6. Enclosure protection level IP2X,
7. The door panel of the switch cabinet is made of pickling phosphating and electrostatic spraying process, so that its surface has strong impact resistance, corrosion resistance, beautiful appearance and other characteristics, and the color of the cabinet can be customized by the user)

# KYN28-12

Metal armored movable switchgear  
(national grid type)

金属铠装移开式开关柜(国网型)





## KYN28-12 金属铠装移开式开关柜(国网型)

### Metal armored movable switchgear (national grid type)

#### 概述

本产品为三相交流50Hz、额定电压12kV户内成套配电装置。作为发电变电站及工矿企业接受和分配电能之用，并具有对电路实行控制保护和检测等功能。

#### Summary

This product is a three-phase AC 50Hz, rated voltage 12kV indoor complete set of power distribution device. It is used as a power generation substation and industrial and mining enterprises to receive and distribute electrical energy, and has the functions of control, protection and detection of circuits.

#### 技术参数

额定工频耐受电压(1min): 42kV  
 额定雷电冲击耐受电压(峰值): 75kV  
 额定短路开断电流: 40kA  
 额定短路关合电流: 100kA  
 额定短时耐受电流及持续时间: 40/4 kA/s温升试验: 1.1r  
 额定峰值耐受电流: 100kA辅助和控制回路短时工频耐受电压: 2kV  
 局部放电试验电压: 1.1x12  
 局部放电单个绝缘件: ≤3pC  
 防护等级外壳: IP4X  
 防护等级隔室间: IP2X  
 爬电距离 瓷质材料(对地): ≥216mm  
 爬电距离 有机材料(对地): ≥240mm  
 相间及相对地净距(空气绝缘): ≥125mm  
 丧失运行连续性类别: LSC2  
 SMC隔板(若有)到带电导体的最小净距: ≥30mm  
 SMC隔板厚度: >5  
 冷却方式: 自冷\*  
 内部电弧允许持续时间: 1s  
 注: \*额定电流>3150A时需采用风冷。

#### Technical parameter

Rated power frequency withstand voltage (1min): 42kV  
 Rated lightning shock withstand voltage (peak): 75kV  
 Rated short-circuit breaking current: 40kA  
 Rated short-circuit closing current: 100kA  
 Rated short-term withstand current and duration: 40/4 kA/s  
 Rated peak withstand current: 100kA Auxiliary and control loop short-time power frequency withstand voltage: 2kV  
 Rated voltage: 12kV  
 Rated frequency: 50Hz  
 Rated current: ≤4000A  
 Temperature rise test: 1.1r  
 Partial discharge test voltage: 1.1x12  
 Partial Discharge Individual Insulation: ≤3pC  
 Degree of protection Housing: IP4X  
 Degree of protection Between compartments: IP2X  
 Creepage distance Porcelain material (to the ground): ≥216mm  
 Creepage Distance Organic Material (to Ground): ≥240mm  
 Phase and relative ground clearance (air insulation): ≥125mm  
 Loss of Operational Continuity Category: LSC2  
 Minimum clearance from SMC separator (if any) to live conductor: ≥30mm  
 SMC Bulkhead Thickness: >5  
 Cooling Method: Self-cooling\*  
 Internal arc allowable duration: 1s  
 Note: \*Air cooling is required when the rated current > 3150A.

#### 产品优势与特点

1. 产品型号: KYN28-12;
2. 使用环境: 户内, 海拔高度≤1000;
3. 柜体尺寸: 柜宽600-1000, 柜深1450-1750, 柜高2240 (以上尺寸, 均为主框架本体尺寸);
4. 结构型式: 铠装、移开式户内高压交流金属封闭开关设备;
5. 结构特点: 主框架侧板采用数控多重折弯工艺加工后栓接而成, 零件具有较高的加工精度和强度, 从而整体提高了开关柜的精度和稳定性;

#### Product advantages and characteristics

1. Product model: KYN28-12;
2. Use environment: indoor; altitude ≤ 1000;
3. Cabinet size: cabinet width 600-1000, cabinet depth 1450-1750, cabinet height 2240 (above size, All are the main frame body sizes);
4. Structure type: armored and removable indoor high-voltage AC metal enclosed switchgear;
5. Structural characteristics: The side panel of the main frame is bolted after processing by CNC multiple bending process, and the parts have high processing accuracy and strength, thus improving the accuracy and stability of the switchgear as a whole.

# KYN28-12

Metal armored central removable  
switchgear

金属铠装高低中置移开式开关柜



## KYN28-12

### 金属铠装高低中置移开式开关柜

# Metal armor high and low mid-mounted removable switchgear

#### 概述 Summary

本产品为三相交流50Hz、额定电压12kV户内成套配电装置。作为发电厂、变电站及工矿企业接受和分配电能之用，并具有对电路实行控制、保护和检测等功能。

#### Summary

This product is a three-phase AC 50Hz, rated voltage 12kV indoor complete set of power distribution device. It is used as a power generation substation and industrial and mining enterprises to receive and distribute electrical energy, and has the functions of control, protection and detection of circuits.

#### 技术参数

额定工频耐受电压(1min): 42kV  
 额定雷电冲击耐受电压(峰值): 75kV  
 额定短路开断电流: 40kA  
 额定短路关合电流: 100kA  
 额定短时耐受电流及持续时间: 40/4 kA/s  
 额定峰值耐受电流: 100kA  
 局部放电试验电压: 1.1x12  
 局部放电 单个绝缘件: ≤3pC  
 防护等级 外壳: IP4X  
 防护等级 隔室间: IP2X  
 爬电距离 瓷质材料(对地): ≥216mm  
 爬电距离 有机材料(对地): ≥240mm  
 相间及相对地净距(空气绝缘): ≥125mm  
 丧失运行连续性类别: LSC2  
 SMC隔板(若有)到带电导体的最小净距: ≥30mm  
 SMC隔板厚度: >5  
 冷却方式: 自冷\*  
 内部电弧允许持续时间: 1s  
 注:\*额定电流>3150A时需采用风冷。

额定电压: 12kV  
 额定频率: 50Hz  
 额定电流: ≤4000A  
 温升试验: 1.1r

#### Technical parameter

Rated power frequency withstand voltage (1min): 42kV  
 Rated lightning shock withstand voltage (peak): 75kV  
 Rated short-circuit breaking current: 40kA  
 Rated short-circuit closing current: 100kA  
 Rated short-term withstand current and duration: 40/4 kA/s  
 Rated peak withstand current: 100kA  
 Auxiliary and control loop short-time power frequency withstand voltage: 2kV  
 Rated voltage: 12kV  
 Rated frequency: 50Hz  
 Rated current: ≤4000A  
 Temperature rise test: 1.1r  
 Partial discharge test voltage: 1.1x12  
 Partial Discharge Individual Insulation: ≤3pC  
 Degree of protection Housing: IP4X  
 Degree of protection Between compartments: IP2X  
 Creepage distance Porcelain material (to the ground): ≥216mm  
 Creepage Distance Organic Material (to Ground): ≥240mm  
 Phase and relative ground clearance (air insulation): ≥125mm  
 Loss of Operational Continuity Category: LSC2  
 Minimum clearance from SMC separator (if any) to live conductor: ≥30mm  
 SMC Bulkhead Thickness: >5  
 Cooling Method: Self-cooling\*  
 Internal arc allowable duration: 1s  
 Note: \*Air cooling is required when the rated current > 3150A.

#### 产品优势与特点

- 1 产品型号: KYN28-12;
- 2 使用环境: 户内, 海拔高度≤1000;
- 3 柜体尺寸: 柜宽600-1000, 柜深1450-1750, 柜高2240 (以上尺寸, 均为主框架本体尺寸);
- 4 结构型式: 铠装、移开式户内高压交流金属封闭开关设备;
- 5 结构特点: 主框架侧板采用数控多重折弯工艺加工后栓接而成。零件具有较高的加工精度和强度, 从而整体提高了开关柜的精度和稳定性;

#### Product advantages and characteristics

1. Product model: KYN28-12;
2. Use environment: indoor, altitude ≤ 1000;
3. Cabinet size: cabinet width 600-1000, cabinet depth 1450-1750, cabinet height 2240 (above size). All are the main frame body sizes.
4. Structure type: armored and removable indoor high-voltage AC metal enclosed switchgear;
5. Structural characteristics: The side panel of the main frame is bolted after processing by CNC multiple bending process, and the parts have high processing accuracy and strength, thus improving the accuracy and stability of the switchgear as a whole.

# KYN28-12

Metal armored central removable  
switchgear

金属铠装平顶中置移开式开关柜





## KYN28-12

### 金属铠装平顶中置移开式开关柜

# Metal armored flat top centralremovable switchgear

#### 概述

本产品为三相交流50Hz、额定电压12kV户内成套配电装置。作为发电厂、变电站及工矿企业接受和分配电能之用，并具有对电路实行控制、保护和检测等功能。

#### Summary

This product is a three-phase AC 50Hz, rated voltage 12kV indoor complete set of power distribution device. It is used as a power generation substation and industrial and mining enterprises to receive and distribute electrical energy, and has the functions of control, protection and detection of circuits.

#### 技术参数

额定工频耐受电压(1min): 42kV  
 额定雷电冲击耐受电压(峰值): 75kV  
 额定短路开断电流: 40kA  
 额定短路关合电流: 100kA  
 额定短时耐受电流及持续时间: 40/4 kA/s  
 额定峰值耐受电流: 100kA辅助和控制回路短时工频耐受电压: 2kV  
 局部放电 试验电压: 1.1x12  
 局部放电 单个绝缘件: ≤3pC  
 防护等级 外壳: IP4X  
 防护等级 隔室间: IP2X  
 爬电距离 瓷质材料(对地): ≥216mm  
 爬电距离 有机材料(对地): ≥240mm  
 相间及相对地净距(空气绝缘): ≥125mm  
 丧失运行连续性类别: LSC2  
 SMC隔板(若有)到带电导体的最小净距: ≥30mm  
 SMC隔板厚度: >5  
 冷却方式: 自冷\*  
 内部电弧允许持续时间: 1s  
 注:\*额定电流>3150A时需采用风冷。

#### Technical parameter

Rated power frequency withstand voltage (1min): 42kV  
 Rated lightning shock withstand voltage (peak): 75kV  
 Rated short-circuit breaking current: 40kA  
 Rated short-circuit closing current: 100kA  
 Rated short-term withstand current and duration: 40/4 kA/s  
 Rated peak withstand current: 100kA Auxiliary and control loop short-time power frequency withstand voltage: 2kV  
 Rated voltage: 12kV  
 Rated frequency: 50Hz  
 Rated current: ≤4000A  
 Temperature rise test: 1.1r  
 Partial discharge test voltage: 1.1x12  
 Partial Discharge Individual Insulation: ≤3pC  
 Degree of protection Housing: IP4X  
 Degree of protection between compartments: IP2X  
 Creepage distance Porcelain material (to the ground): ≥ 216mm  
 Creepage Distance Organic Material (to Ground): ≥240mm  
 Phase and relative ground clearance (air insulation): ≥125mm  
 Loss of Operational Continuity Category: LSC2  
 Minimum clearance from SMC separator (if any) to live conductor: ≥30mm  
 SMC Bulkhead Thickness: >5  
 Cooling Method: Self-cooling\*  
 Internal arc allowable duration: 1s  
 Note: \*Air cooling is required when the rated current > 3150A.

#### 产品优势与特点

1. 产品型号: KYN28-12;
2. 使用环境: 户内, 海拔高度≤1000;
3. 柜体尺寸: 柜宽600~1000, 柜深1450~1750, 柜高2240 (以上尺寸, 均为主框架本体尺寸);
4. 结构型式: 铠装、移开式户内高压交流金属封闭开关设备;
5. 结构特点: 主框架侧板采用数控多重折弯工艺加工后拼接而成, 零件具有较高的加工精度和强度, 从而整体提高了开关柜的精度和稳定性;

#### Product advantages and characteristics

1. Product model: KYN28-12;
2. Use environment: indoor, altitude ≤ 1000;
3. Cabinet size: cabinet width 600-1000, cabinet depth 1450-1750, cabinet height 2240 (above size, All are the main frame body sizes).
4. Structure type: armored and removable indoor high-voltage AC metal enclosed switchgear;
5. Structural characteristics: The side panel of the main frame is bolted after processing by CNC multiple bending process, and the parts have high processing accuracy and strength, thus improving the accuracy and stability of the switchgear as a whole.

# KYN61-40.5

Armored removable AC metal  
enclosed switchgear

铠装移开式交流金属封闭开关柜





## KYN61-40.5

### 铠装移开式交流金属封闭开关柜

## Armored removable AC metal enclosed switchgear

#### 概述

本产品为三相交流50Hz、额定电压12kV户内成套配电装置。作为发电厂、变电站及工矿企业接受和分配电能之用，并具有对电路实行控制、保护和检测等功能。

#### Summary

This product is a three-phase AC 50Hz, rated voltage 12kV indoor complete set of power distribution device. It is used as a power generation substation and industrial and mining enterprises to receive and distribute electrical energy, and has the functions of control, protection and detection of circuits.

#### 技术参数

额定工频耐受电压(1min): 42kV  
 额定雷电冲击耐受电压(峰值): 75kV  
 额定短路开断电流: 40kA  
 额定短路关合电流: 100kA  
 额定短时耐受电流及持续时间: 40/4 kA/s  
 额定峰值耐受电流: 100kA辅助和控制回路短时工频耐受电压: 2kV  
 局部放电试验电压: 1.1x12  
 局部放电单个绝缘件: ≤3pC  
 防护等级 外壳: IP4X  
 防护等级 隔室间: IP2X  
 爬电距离 瓷质材料(对地): ≥216mm  
 爬电距离 有机材料(对地): ≥240mm  
 相间及相对地净距(空气绝缘): ≥125mm  
 丧失运行连续性类别: LSC2  
 SMC隔板(若有)到带电导体的最小净距: ≥30mm  
 SMC隔板厚度: >5  
 冷却方式: 自冷\*  
 内部电晕允许持续时间: 1s  
 注:\*额定电流>3150A时需采用风冷。

#### Technical parameter

Rated power frequency withstand voltage (1min): 42kV  
 Rated lightning shock withstand voltage (peak): 75kV  
 Rated short-circuit breaking current: 40kA  
 Rated short-circuit closing current: 100kA  
 Rated short-term withstand current and duration: 40/4 kA/s  
 Rated peak withstand current: 100kA Auxiliary and control loop short-time power frequency withstand voltage: 2kV  
 Rated voltage: 12kV  
 Rated frequency: 50Hz  
 Rated current: ≤4000A  
 Temperature rise test: 1.1Ir  
 Partial discharge test voltage: 1.1x12  
 Partial Discharge Individual Insulation: ≤3pC  
 Degree of protection Housing: IP4X  
 Degree of protection between compartments: IP2X  
 Creepage distance Porcelain material (to the ground): ≥ 216mm  
 Creepage Distance Organic Material (to Ground): ≥240mm  
 Phase and relative ground clearance (air insulation): ≥125mm  
 Loss of Operational Continuity Category: LSC2  
 Minimum clearance from SMC separator (if any) to live conductor: ≥30mm  
 SMC Bulkhead Thickness: >5  
 Cooling Method: Self-cooling\*  
 Internal arc allowable duration: 1s  
 Note: \*Air cooling is required when the rated current > 3150A.

#### 产品优势与特点

1. 产品型号: KYN28-12;
2. 使用环境: 户内, 海拔高度≤1000;
3. 柜体尺寸: 柜宽600~1000, 柜深1450~1750, 柜高2240 (以上尺寸, 均为主框架本体尺寸);
4. 结构型式: 铠装、移开式户内高压交流金属封闭开关设备;
5. 结构特点: 主框架侧板采用数控多重折弯工艺加工后拼接而成。零件具有较高的加工精度和强度, 从而整体提高了开关柜的精度和稳定性。

#### Product advantages and characteristics

1. Product model: KYN28-12;
2. Use environment: indoor, altitude ≤ 1000;
3. Cabinet size: cabinet width 600-1000, cabinet depth 1450-1750, cabinet height 2240 (above size, All are the main frame body sizes).
4. Structure type: armored and removable indoor high-voltage AC metal enclosed switchgear;
5. Structural characteristics: The side panel of the main frame is bolted after processing by CNC multiple bending process, and the parts have high processing accuracy and strength, thus improving the accuracy and stability of the switchgear as a whole.

# 60/80/120/160kW 单双枪

Floortype Dc charging pile  
60/80/120/160kw single and double gun

落地式直流充电桩



## 落地式直流充电桩

### 60/80/120/160kW 单双枪

## Floor type Dc charging pile

### 60/80/120/160kw single and double gun

#### 概述

本产品主要由人机交互触摸屏、读卡器、电能计量模块、充电模块、通讯模块、充电接口、控制模块和柜体组成。充电桩具有多重保护功能，输入输出具备双重安全保护措施，充电时可实时监测充电电缆的连接状态，连接异常时立即停止充电，确保充电过程中的人身和车辆安全。人性化的界面显示和控制引导功能，让客户方便完成充电过程，对外提供以太网、GPRS等多种通信接口，与监控中心、运营管理中心实时通信，实时监测充电状态。

#### Summary

This product is mainly composed of human-computer interaction touch screen, card reader, electric energy metering module, charging module, communication module, charging interface, control module and pile. The charging pile has multiple protection functions, and the input and output have dual safety protection measures. During charging, the connection state of the charging cable can be monitored in real time, and the charging can be terminated immediately in case of abnormal connection, so as to ensure the personal and vehicle safety during charging. Humanized interface display and control guidance function make it convenient for customers to complete the charging process. Provide Ethernet, GPRS and other communication interfaces to communicate with the monitoring center and operation management center in real time to monitor the charging state in real time.

#### 技术参数

产品型号: XJAC/14KW  
设备尺寸: 1400\*300\*160  
安装方式: 壁挂式 立柱式  
走线方式: 下进下出  
线缆长度: 5M  
输入电压: AC220V±20%  
输入频率: 50±3Hz  
额定功率: 14kW  
输出电流: 32A\*32A  
人机界面: 4.3寸触摸屏  
通讯接口: 支持 4G/3G/2G、以太网(自组网)/小程序  
安规标准: GB 20234、GB 18487、NBT 33008、NBT 33002  
保护设计: 过压保护、欠压保护、过流保护、短路保护、漏电保护、接地保护、过温保护、低温保护、防雷保护、急停保护  
充电方式: 刷卡、扫码、即插即充  
使用环境: 户内/户外  
工作温度: -45°C~+50°C  
防护等级: IP54

#### Technical parameter

Product Model: XJAC/14KW  
Equipment Size: 1400\*300\*160  
Installation method: wall-mounted column type  
Wiring method: down and out  
Cable Length: 5M  
Input Voltage: AC220V ±20%  
Input Frequency: 50 Hz ±3Hz  
Rated power: 14KW  
Output Current: 32A \*32A  
HMI: 4.3-inch touch screen  
Communication interface: Support 4G/3G/2G, Ethernet (ad hoc network)/applet  
Safety standards: GB 20234, GB 18487, NBT 33008, NBT 33002  
Protection design: overvoltage protection, undervoltage protection, overload protection, short circuit protection, leakage protection, grounding protection, over-temperature protection, low temperature protection, lightning protection, emergency stop protection  
Charging method: swipe card, scan code, plug and charge  
Usage Environment: Indoor/Outdoor  
Operating temperature: -45°C~+50°C  
Protection Level: IP54

# 14kW

Floor type single and double  
gunAC charging pile

落地式单双枪交流充电桩





## 14kW

## 落地式单双枪交流充电桩

## Floor type single and double gun AC charging pile

## 概述

冷轧钢+静电喷塑，外壳坚固，抗压，抗冲击支持刷卡扫码充电，触控屏更适合用户操作建站运营，室内外停车场，商场的最佳选择充电桩而且符合人体工学设计，防水等级IP54,适合室外安装使用。

## Summary

Cold rolled steel+electrostatic spray molding, sturdy shell, compressive resistance, impact resistance, support for card swiping and code scanning charging, touch screen is more suitable for user operation, station building and operation, indoor and outdoor parking lots, and the best choice for shopping malls. The charging gun is fashionable and ergonomically designed, with a waterproof grade of IP54, suitable for outdoor installation and use.

## 技术参数

## Technical parameter

规格型号: XJDC-1000V/240kW XJDC-1000V/360kW  
WXJDC-1000V/480kW WXDC-1000V/720kW

外形尺寸: 2200mm\*1060mm\*1000mm(H\*W\*D)

安装方式: 地式安装

进线方式: 下进下出

输入电压: AC380V±15%

输入频率: 50Hz±1

输出电压: 200-1000VDC

外形尺寸: 1500mm\*420mm\*240mm(H\*W\*D)

人机界面: 7寸触摸屏

输入交流电压: AC220V±20%

输入频率: 50Hz±1

直流输入: 200-1000VDC

直流输出: 200-1000VDC

单枪输出电流: 0-250A

充电桩数量: 6/1

枪线长度: 25米(可根据客户需求定制长度)

安装方式: 落地式安装

浪涌保护值: ≥110V

稳压精度: ≤±0.5%

稳流精度: ≤±1%

波纹系数: ≤±0.5%

效率: ≥95%

充电模式: 自动充满/定量/定金额/定时间

充电方式: 刷卡/扫码

通信接口: 4G/以太网

执行标准: GB/T20234, GB/T18487, NB/T33008, GB/T27930

安全功能: 充电桩温度检测, 过压保护, 欠压保护, 过载保护, 短路保护, 接地保护, 过温保护, 低温保护绝缘监测保护, 极性反接保护, 防雷保护, 急停保护, 漏电保护

工作温度: -45°C~+55°C

工作湿度: 5%~95%无凝霜

海拔高度: <2000m

防护等级: IP54

冷却方式: 强制冷风, 独立风道/液冷/全液冷

Specifications: XJDC-1000V/240kW XJDC-1000V/360kW  
WXJDC-1000V/480kW WXDC-1000V/720kW

Overall Dimension: 2200mm\*1060mm\*1000mm(H\*W\*D)

Installation method: Ground installation

Line in: down and out

Input Voltage: AC380V±15%

Input Frequency: 50Hz±1

Output Voltage: 200-1000VDC

Overall Dimension: 1500mm\*420mm\*240mm(H\*W\*D)

HMI: 7-inch touch screen

Input AC Voltage: AC220V±20%

Input Frequency: 50Hz±1

DC input: 200-1000VDC

DC Output: 200-1000VDC

Single Gun Output Current: 0-250A

Number of charging cables: 6/1

Gun Line Length: 25 m (Length can be customized according to customer needs)

Installation Method: Floor-mounted installation

Current Limit Protection Value: ≥110V

Voltage regulation accuracy: ≤±0.5%

Steady flow accuracy: ≤±1%

Corrugation Coefficient: ≤±0.5%

Efficiency: ≥95%

Charging mode: automatic full charge/fixed charge/fixed amount/fixed time

Charging method: Swipe card/scan code

Communication interface: 4G/Ethernet

Executive standards: GB/T20234, GB/T18487, NB/T33008, GB/T27930

Safety functions: charging gun temperature detection, overvoltage protection, undervoltage protection, overload protection, short circuit protection, grounding protection, over-temperature protection, low-temperature protection, insulation monitoring protection, polarity reverse connection protection, lightning protection, emergency stop protection, leakage protection

Operating Temperature: -45°C~55°C

Working humidity: 5%~95% non-condensation

Altitude: <2000m

Degree of protection: IP54

Cooling Method: Forced cold air, independent air duct/liquid cooling/full liquid cooling

# 7kW

Wall-mounted electric  
Ac charging pile 7kW

壁挂式电动汽车交流充电桩





## 7kW

## 壁挂式电动汽车交流充电桩

Wall-mounted electric  
Ac charging pile

## 概述 Summary

1. 外形时尚简约,是家用、社区、社会公共充电的理想选择;
2. 机身采用镀锌+PC材质,人机交互界面,多重电气安全保护设计一体;
3. 防水等级IP54,适应室内外使用,安装便捷。产品设计遵循环保、低能耗原则,节能省电,待机功率低,降低运营额外成本;
4. 支持本地支付,可设置为即插即充,刷卡充电、扫码充电、移动支付等多种支付方式。

## Summary

1. Stylish and minimalist design: an ideal choice for home, community, and public charging;
2. The casing is made of galvanized PC material, featuring an interactive interface and multiple electrical safety protection designs;
3. Waterproof rating IP54, suitable for indoor and outdoor use, easy to install. The product design follows environmental protection principles, low energy consumption, energy-saving, low standby power, and reduced operational costs;
4. Supports local payments and can be set for plug-and-charge; multiple payment methods including card charging, QR code charging, and mobile payments.

## 技术参数 Technical parameter

产品型号: XJAC/7KW  
 产品属性: 镀锌材质+PC  
 设备尺寸: 300\*220\*120mm  
 安装方式: 壁挂式 立柱式  
 走线方式: 下进下出  
 线缆长度: 5M  
 输入电压: 220V±20%  
 输入频率: 50±3Hz  
 额定功率: 7kW  
 输出电流: 32A  
 人机界面: 4.3寸触摸屏  
 通讯接口: 支持 4G/3G/2G, 以太网(自组网)  
 安规标准: GB/T 20234, GB/T 18487, NBT33008, NBT33002  
 保护设计: 过压保护, 欠压保护, 过载保护, 短路保护, 漏电保护, 接地保护, 过温保护, 低温保护, 防雷保护, 急停保护  
 充电方式: 刷卡、扫码、即插即充  
 使用环境: 户内/户外  
 工作温度: -45°C ~ +50°C  
 防护等级: IP54

## Technical parameter

Product model: XJAC/7KW  
 Product attributes: galvanized material PC  
 Equipment size: 300\*220\*120mm  
 Installation method: wall-mounted column type  
 Routing method: down in and out  
 Cable length: 5M  
 Input Voltage: 220V±20%  
 Input frequency: 50±3Hz  
 Rated power: 7kW  
 Output current: 32A  
 HMI: 4.3-inch touch screen  
 Communication interface: Support 4G/3G/2G, Ethernet (ad hoc network)  
 Safety standards: GB/T 20234, GB/T 18487, NBT33008, NBT33002  
 Protection design: overvoltage protection, undervoltage protection, overload protection, short circuit protection, leakage protection, grounding protection, over-temperature protection, low temperature protection, lightning protection, emergency stop protection  
 Charging method: swipe card, scan code, plug and charge  
 Usage environment: indoor/outdoor  
 Operating temperature: -45°C ~ 50°C  
 Degree of protection: IP54

# WHDCC-A系列

## 60/80/120/160/180/240kW

WHDCC-A series floor type third generation DC charging pile  
60/80/120/160/180/240kW single and double gun

落地式第三代直流充电桩



## WHDCC-A系列

### 落地式第三代直流充电桩

#### 60/80/120/160/180/240kw 单双枪

#### WHDCC-A series floor type

#### third generation DC charging pile

#### 60/80/120/160/180/240kW single and double gun

#### 概述 Summary

本产品主要由人机交互触摸屏、读卡器、电能计量模块、充电模块、通讯模块、充电接口、控制模块和箱体组成。充电具有监测充电电缆的连接状态，连接异常时立即终止充电，确保充电过程多重保护功能，输入输出具备双重安全保护措施，充电时可实时中的人身和车辆安全。人性化的界面显示和控制引导功能，让客户方便完成充电过程。对外提供以太网、GPRS等多种通信接口，与监控中心、运营管理中心实时通信，实时监测充电状态。

#### Summary

This product is mainly composed of human-computer interact touch screen, card reader, electric energy metering module, charging and pile. The charging pile has multiple protection functions, and the module, communication module, charging interface, control module, the connection state of the charging cable can be monitored in real input and output have dual safety protection measures. During charging, and the charging can be terminated immediately in case of abnormal connection, so as to ensure the personal and vehicle safety during charging. Convenient for customers to complete the charging process. charging Humanized interface display and control guidance function. Provide Ethernet, GPRS and other communication interfaces to communicate with the monitoring center and operation management center in real time to monitor the charging state in real time.

#### 技术参数 Technical parameter

型号: XJDC-1000V80kW XJDC-1000V160kW XJDC-1000V160kW

额定功率: 60-80kW 120-160kW 180-240kW

枪数: 单双枪

散热方式: 强制冷风/独立风道/液冷/全液冷

后台通讯: 以太网/4G

充电枪线长: 5m(可定制)

外形尺寸(高×宽×深): 1650\*770\*480 1650\*770\*630 1800\*770\*680

输入电压: 380VAC±15%，三相 Three-phase +N+PE

频率: 45Hz-65Hz

电压范围: 50-1000VDC

最大电流: 125A-200A 250A

充电策略: 平均分配

峰值效率: 95%

输出电压误差:  $\leq \pm 0.5\%$

输出电流误差:  $\leq 30A$  时,  $\leq \pm 1\%$ ;  $\leq 30A$  时,  $\leq \pm 0.3A$

稳压精度:  $\leq \pm 0.5\%$

稳流精度:  $\leq \pm 1\%$

纹波峰峰值:  $\leq \pm 1\%$

功率因数:  $\geq 0.99$

谐波:  $\leq 5\%$

工作温度:  $-45 \rightarrow +50^{\circ}C$

存储温度:  $-40 \rightarrow +80^{\circ}C$

相对湿度: 5-90%RH, 无冷凝

海拔高度:  $\leq 2000m$

使用环境: 室内或室外(IP54)

#### Technical parameter

Model: XJDC-1000V80kW XJDC-1000V160kW XJDC-1000V160kW

Rated power: 60-80kW 120-160kW 180-240kW

Number of guns: single and double guns

Heat dissipation mode: forced cold air/independent air duct/liquid cooling/full liquid cooling

Background communication: Ethernet/4G

Charging Gun Cable Length: 5m (Customizable)

Dimensions (H x W x D): 1650\*770\*480 1650\*770\*630 1800\*770\*680

Input voltage: 380VAC 15%, three-phase +N+PE

Frequency: 45Hz-65Hz

Voltage range: 50-1000VDC

Maximum current: 125A-200A 250A

Charging strategy: evenly distributed

Peak Efficiency: 95%

Output Voltage Error:  $\leq \pm 0.5\%$

Output current error:  $\leq 1\%$  at  $\leq 30A$ ;  $< 30A$ ,  $\leq 0.3A$

Voltage regulation accuracy:  $\leq \pm 0.5\%$

Steady flow accuracy:  $\leq \pm 1\%$

Ripple peak:  $\leq \pm 1\%$

Power factor:  $\geq 0.99$

Harmonics:  $\leq 5\%$

Operating temperature:  $-45 \rightarrow 50^{\circ}C$

Storage temperature:  $-40 \rightarrow 80^{\circ}C$

Relative humidity: 5-90%RH, non-condensing

Altitude:  $\leq 2000m$

Usage Environment: Indoor or Outdoor (IP54)



**速尔科技(浙江)股份有限公司**  
**LYE TECHNOLOGY (ZHEJIANG) CO.,LTD**

地址Add: 浙江省温州市洞头区霓盛路1188号  
电话Tel: 0577-61710288  
Http: //www.cnlye.com

